

# PITT

COOKING

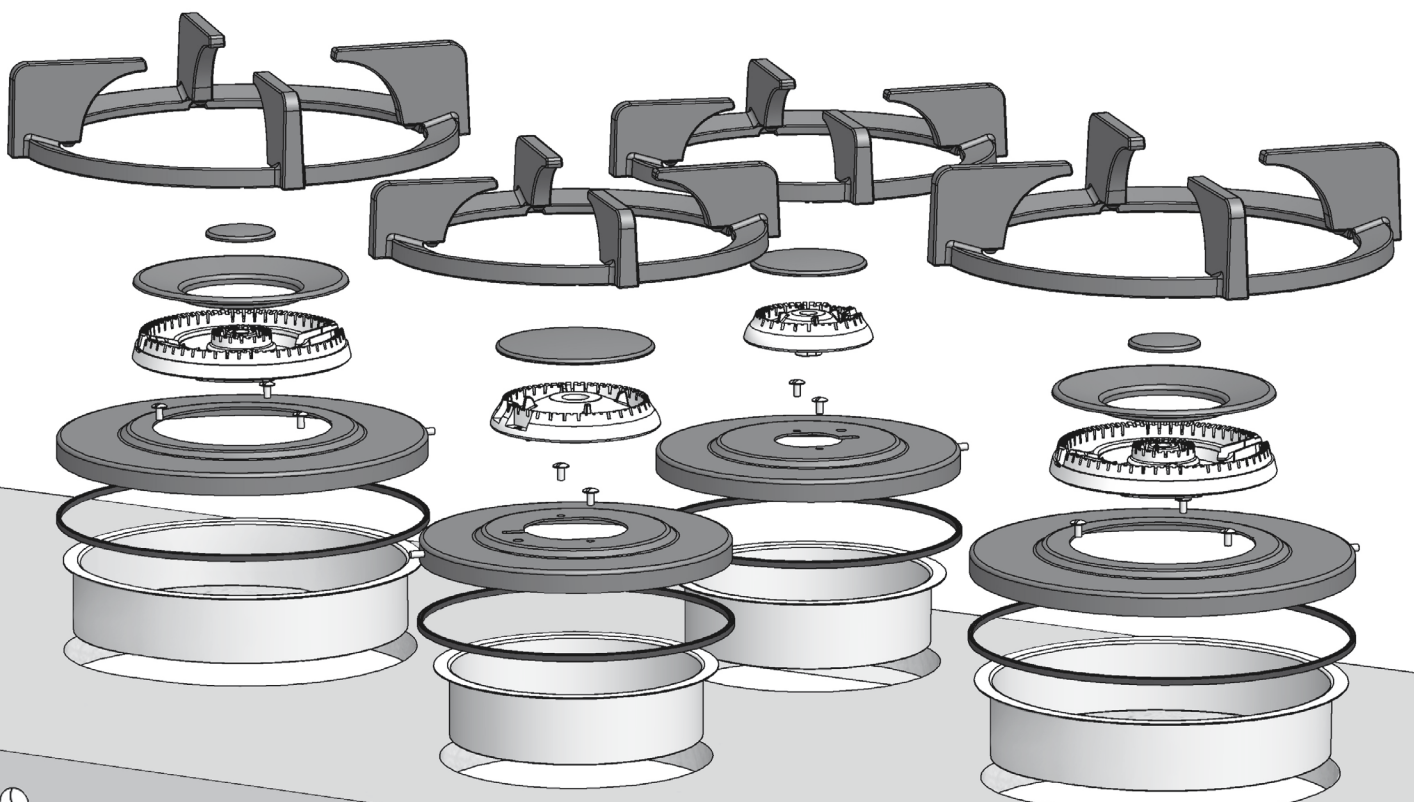

**NL** *Montagehandleiding*

**EN** *Installation instructions*

**FR** *Notice de montage*

**DE** *Montageanleitung*

**ES** *Instrucciones de instalación*

**IT** *Manuale per l'utente*

**Gas  
Front Side**

## Montagehandleiding Front Side

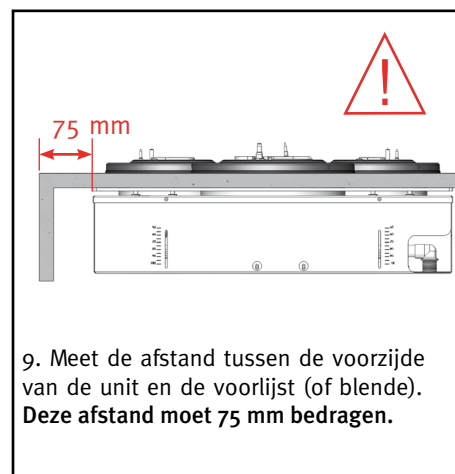
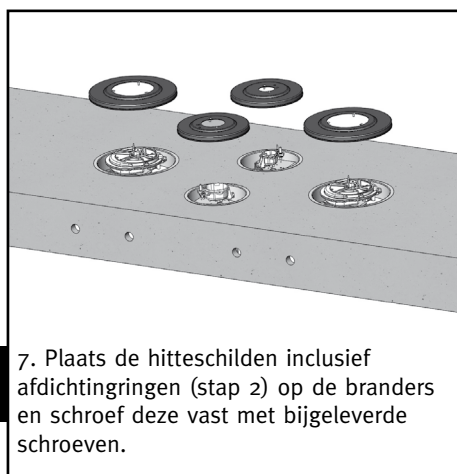
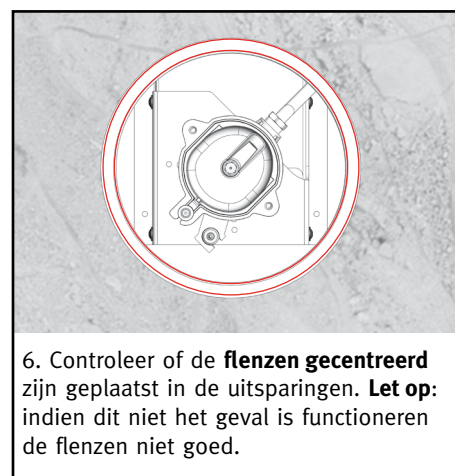
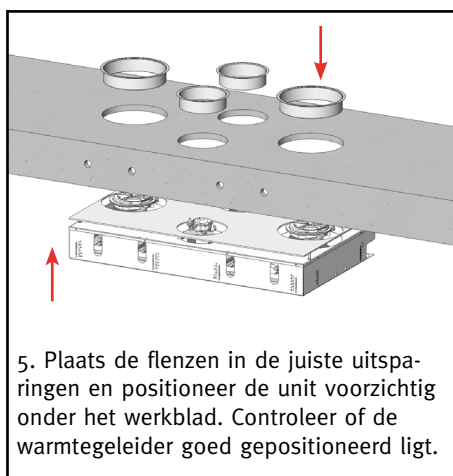
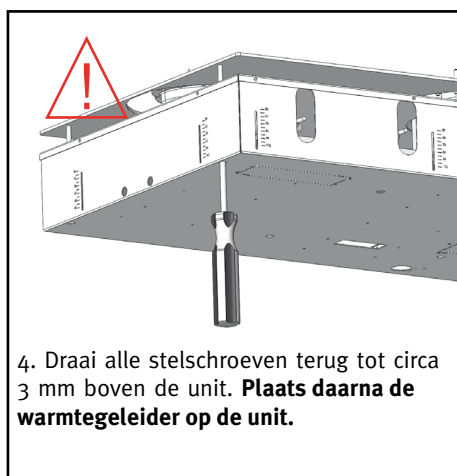
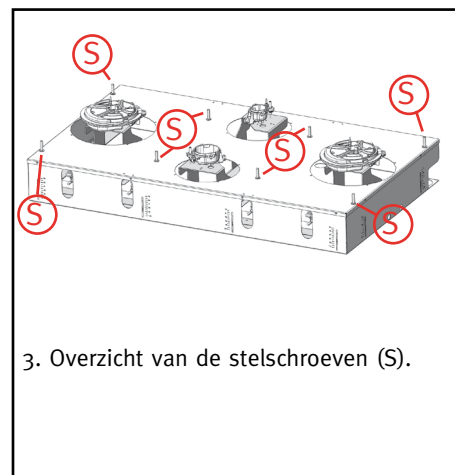

NL



### Belangrijk!

Bij het **niet** juist afstellen van de bedieningsknoppen zullen de branders niet of slecht ontvlammen.

Om de **garantie** en het **goed functioneren van de kookunit** te waarborgen dient de montage, zoals beschreven in deze handleiding, zorgvuldig uitgevoerd te worden.

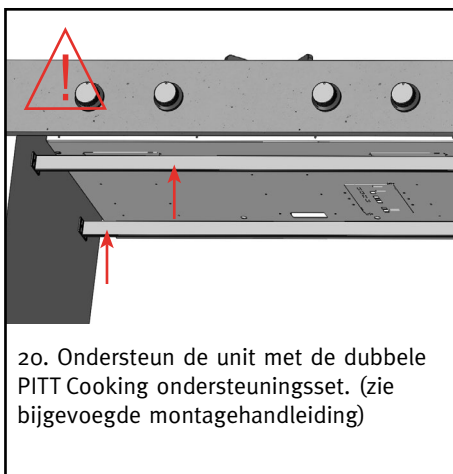
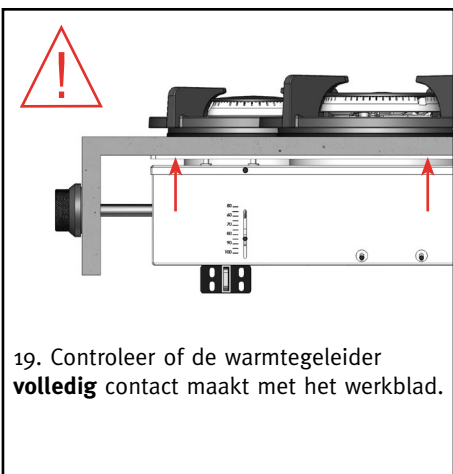
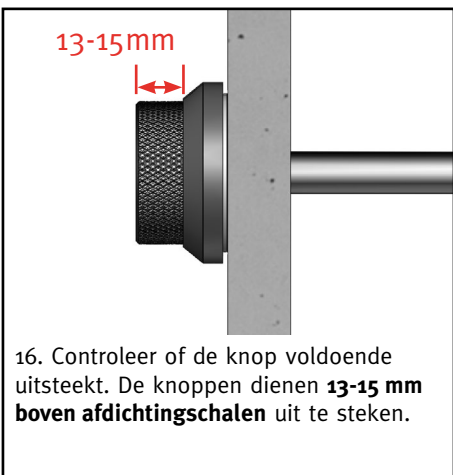
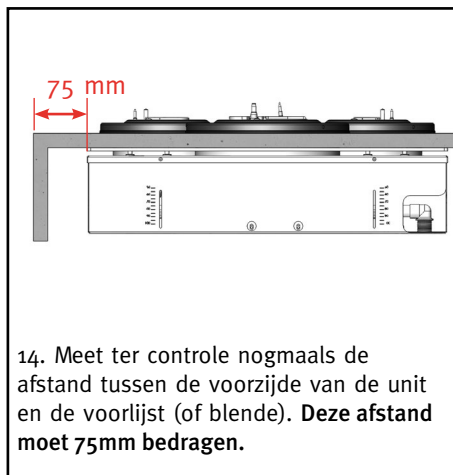
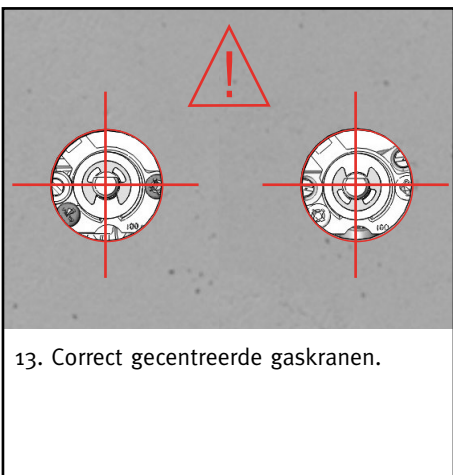
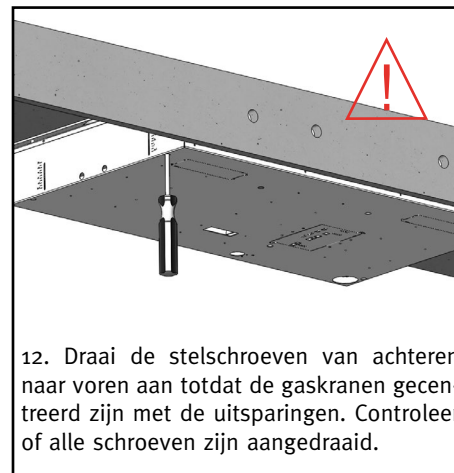
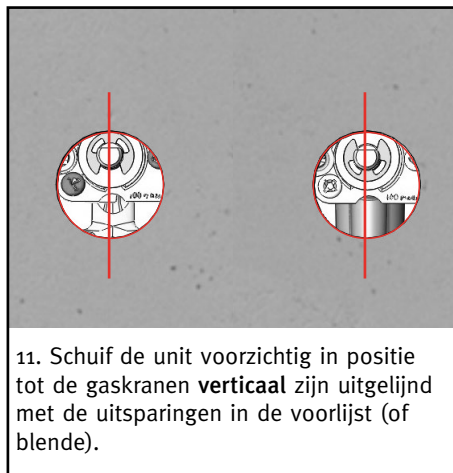

# Montagehandleiding ondersteuningsset

## Inhoud van de verpakking:

2x ondersteuningsbalk



4x inzetstuk



16x kruiskopschroeven 4,2x16 mm



## Benodigd gereedschap:

- Rolmaat
- Kruiskopschroevendraaier
- Metaalzaag



1. Bepaal de maatvoering van de kast en zaag de ondersteuningsbalken af. **LET OP! Juiste lengte balk = Afmeting binnenzijde kast – 4 mm.**

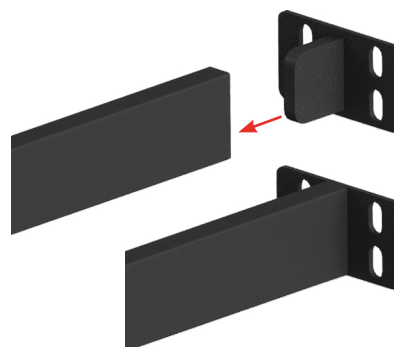

2. Plaats de inzetstukken in de uiteindes van de op maat gezaagde ondersteuningsbalken.

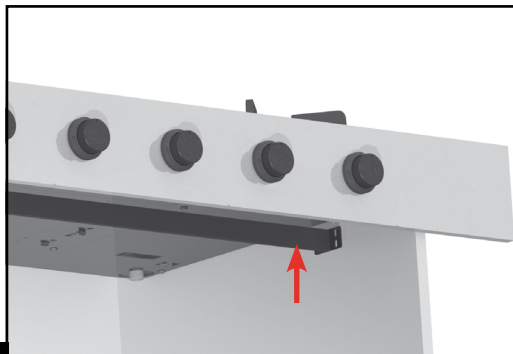

3. Plaats de ondersteuningsbalk tussen de kast, en positioneer deze tegen de onderzijde van de PITT Cooking unit. **LET OP DE POSITIONERING, ZIE STAP 4!**

\* Minimale afstand van 80 mm



4. Positioneer de ondersteuningsbalk zo, dat de stelschroeven, gasaansluiting en het elektrablok vrij toegankelijk zijn.

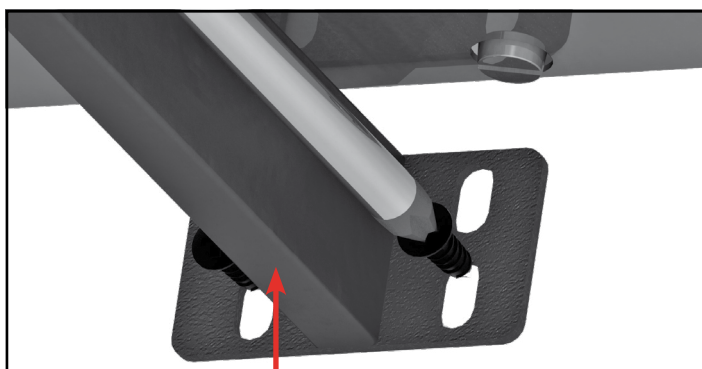

5. Duw de ondersteuningsbalk stevig tegen de onderzijde van de PITT Cooking unit en draai de onderste twee schroeven handvast. Herhaal deze stap voor de andere zijde van de kast.

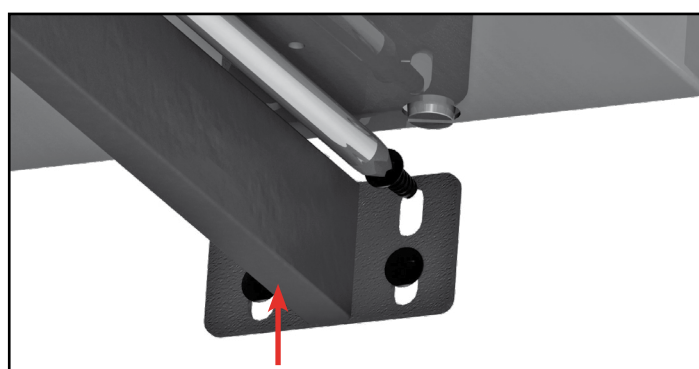

6. Duw de ondersteuningsbalk stevig tegen de onderzijde van de PITT Cooking unit en draai de bovenste twee schroeven volledig aan en vervolgens de onderste schroeven volledig aan.

# PITT

COOKING

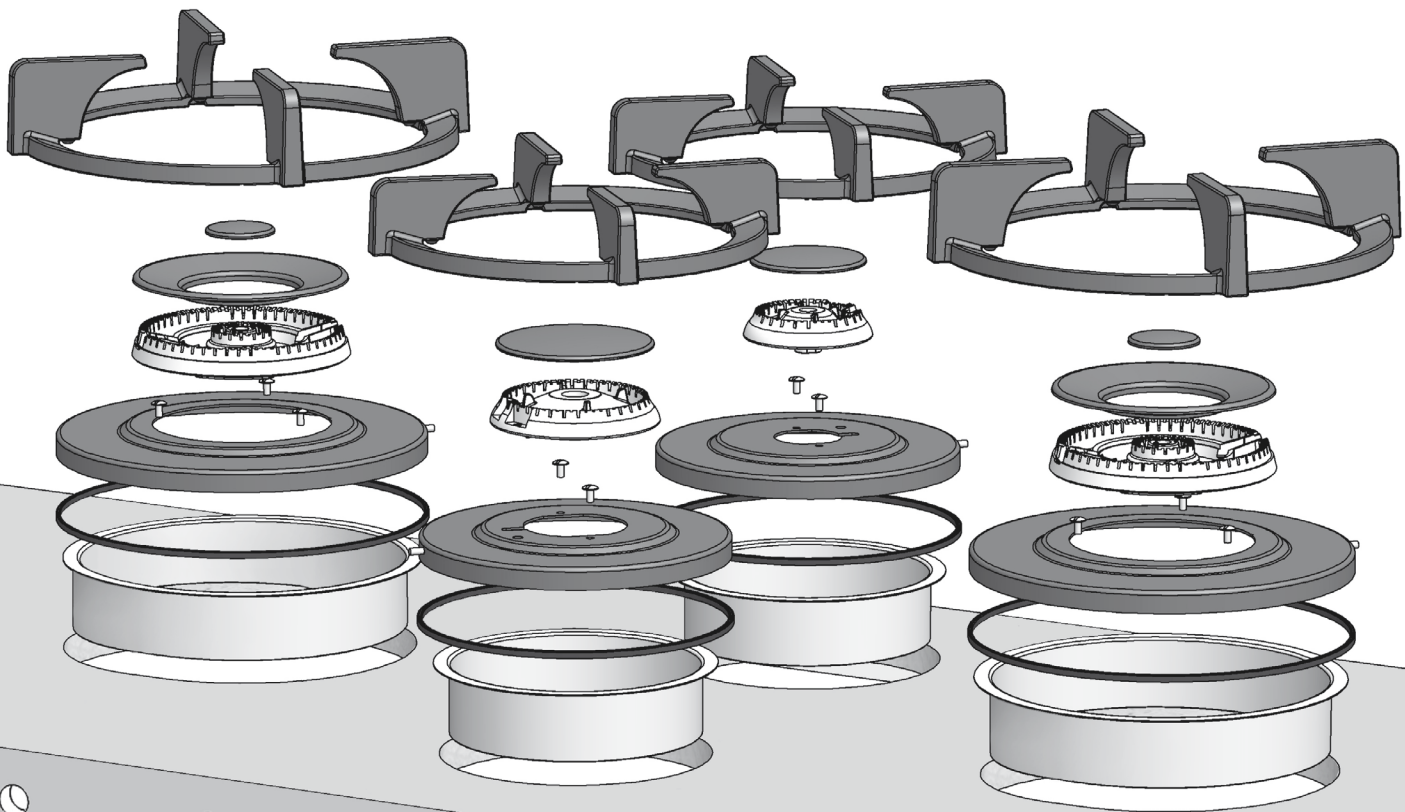

EN *Installation instructions*

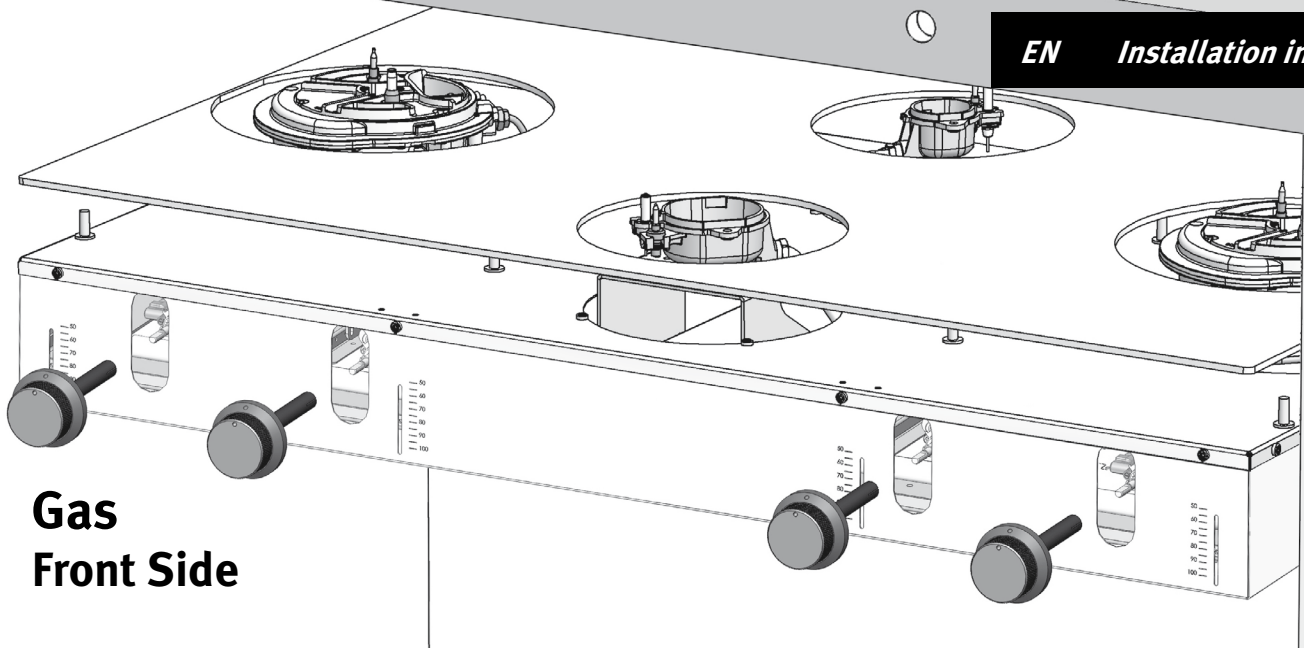

**Gas  
Front Side**

## Installation instructions Front Side

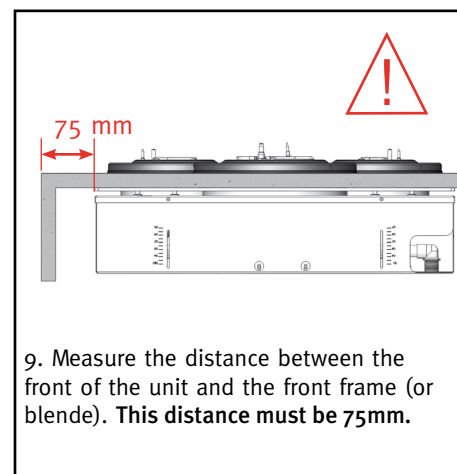
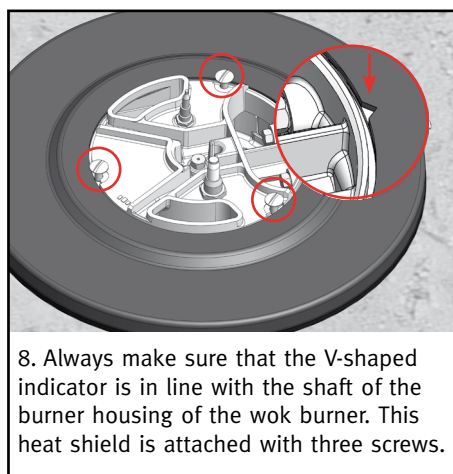
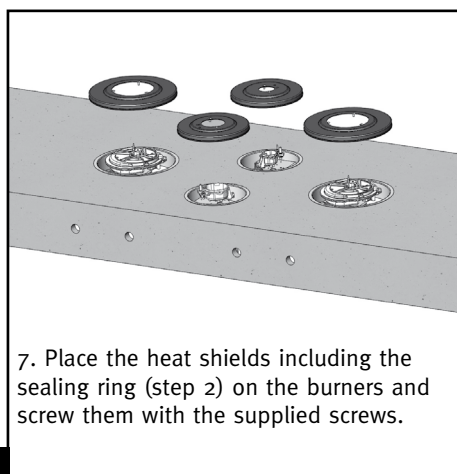
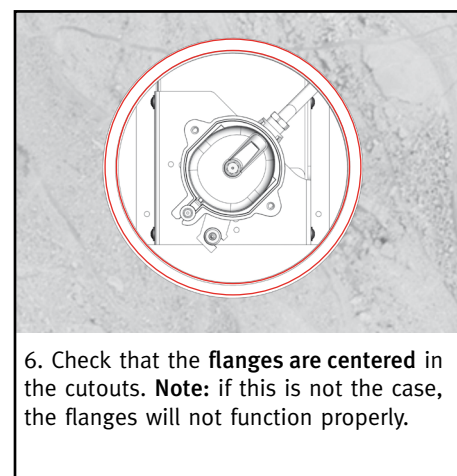
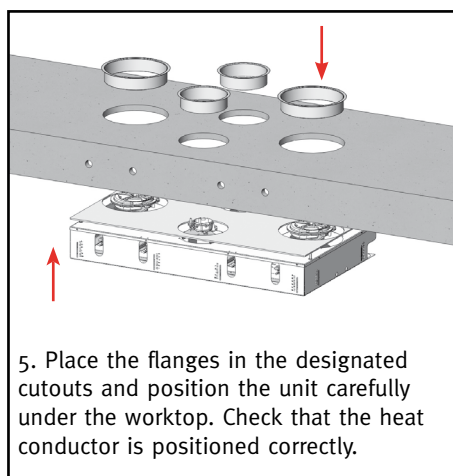
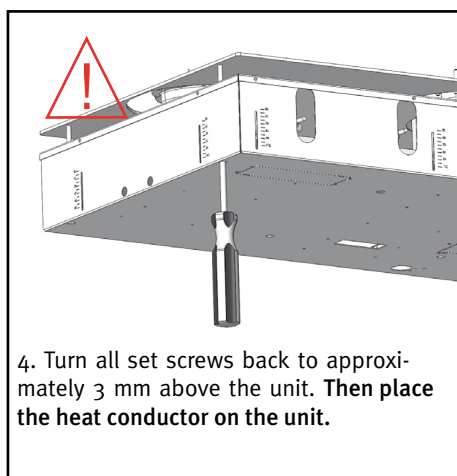
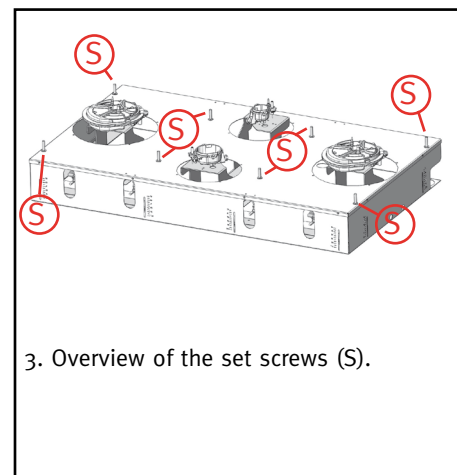
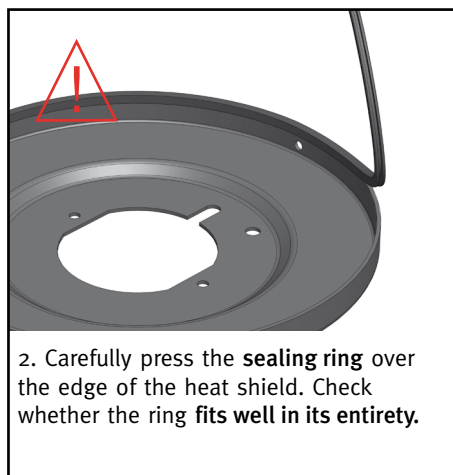
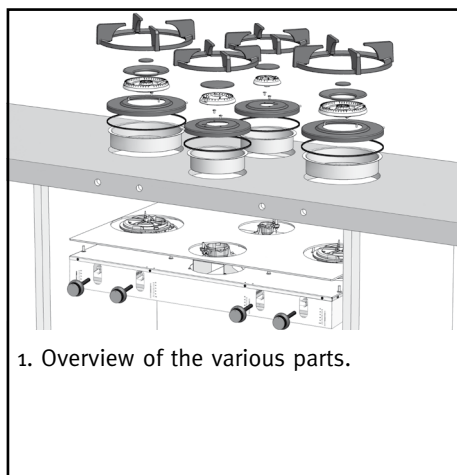

EN



### Important!

When the control knobs are **not** properly adjusted the burners will not ignite or burn evenly.

For **warranty** and the **proper functioning** of the cooking unit ensure the mounting is as described in this manual to the letter.

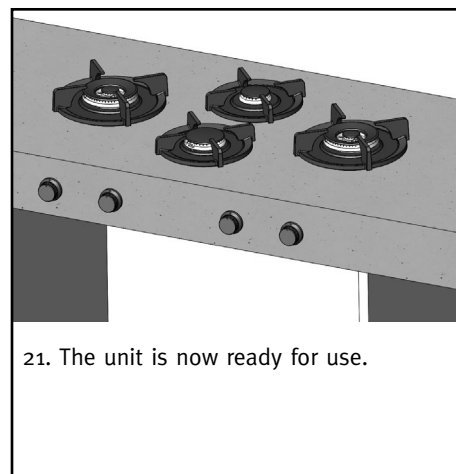
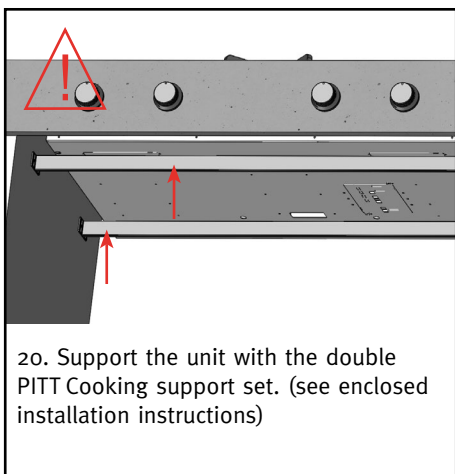
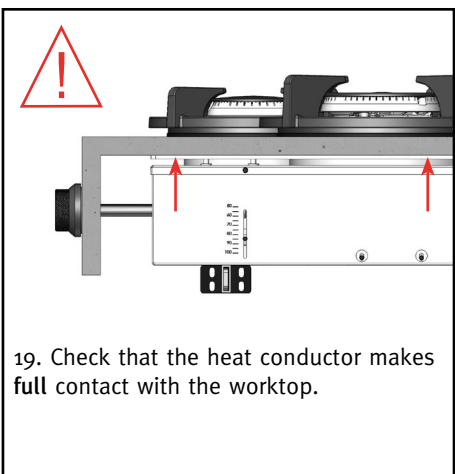
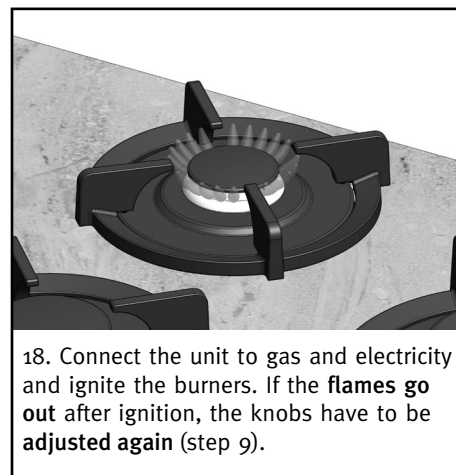
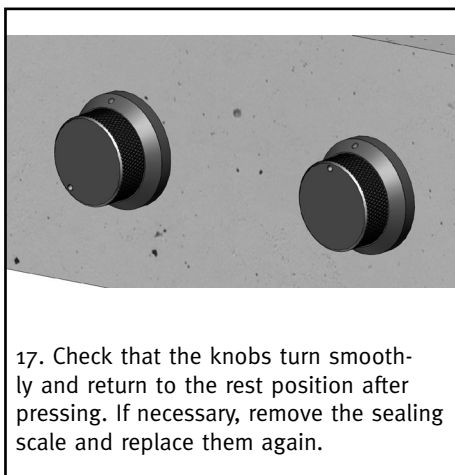
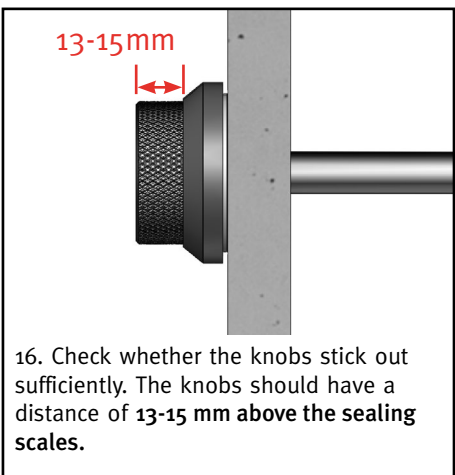
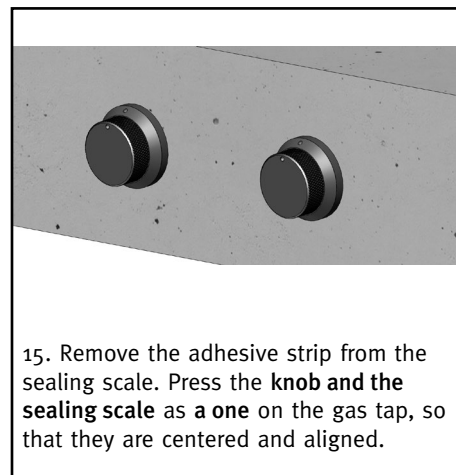
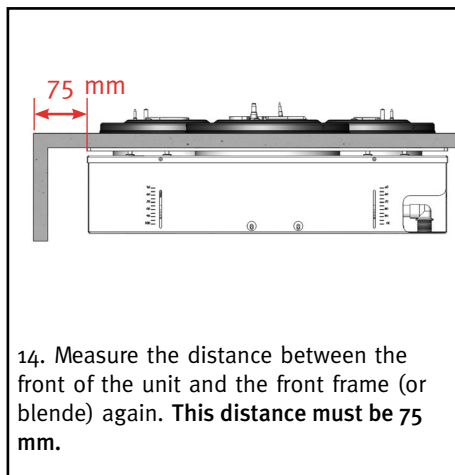
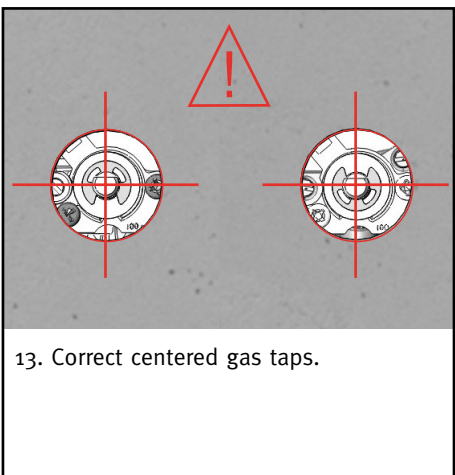
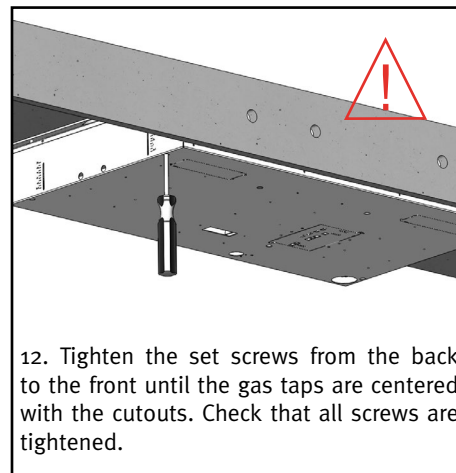
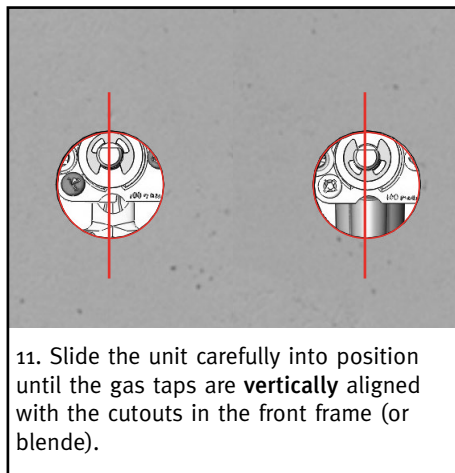

# Instructions for installation of support set

## Contents of package:

2x support beams



4x inserts



16x cross-point screws 4,2x16 mm



## Tools needed:

- Measuring tape
- Cross-point screwdriver
- Metallic saw



1. Determine the dimensions of the cabinet and cut the support beams with the saw. **ATTENTION!** Correct length of the beam = the dimension of cabinet on the inside - 4 mm.

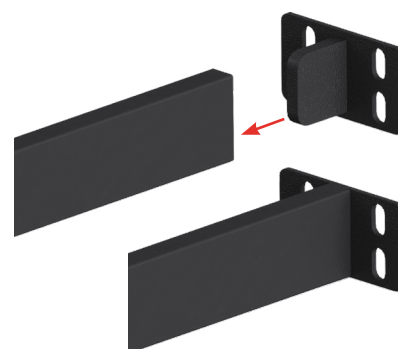

2. Place the inserts into the ends of the beams that have been cut to size.

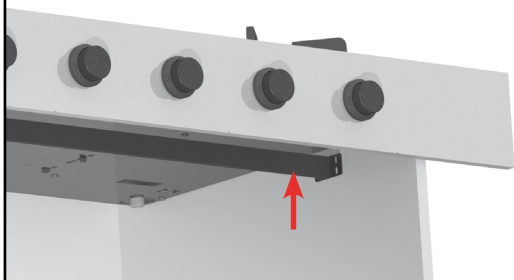

3. Place the beams between the cabinet and position it against the under side of the PITT Cooking unit. **ATTENTION: FOR THE POSITIONING, SEE STEP 4.**

\* Minimum distance of 80 mm

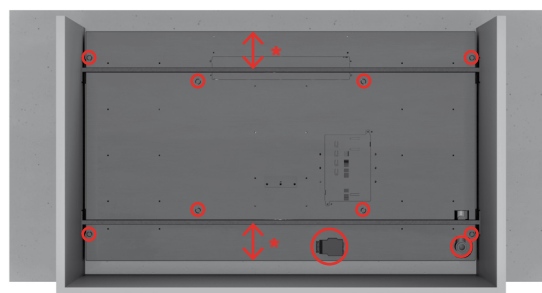

4. Position the beams in such a way that the screws, gas connection and the electricity block are freely accessible.

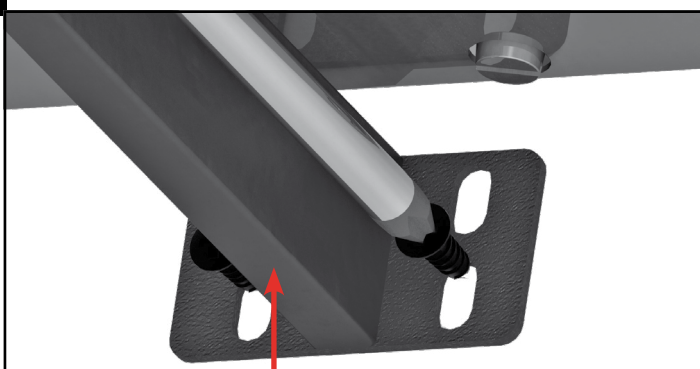

5. Push the beams firmly against the underside of the PITT Cooking unit and tighten the lower two screws by hand. Repeat this step for the other side of the cabinet.

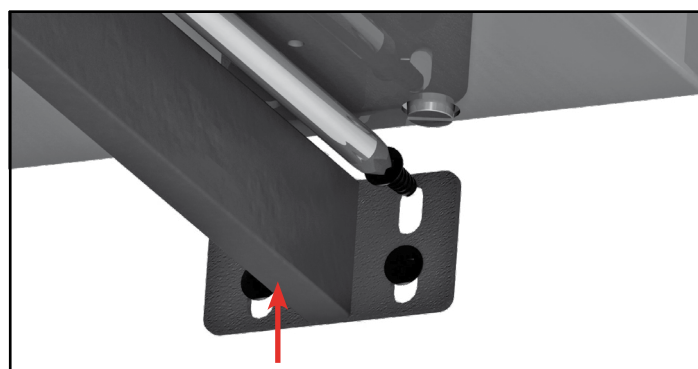

6. Push the beams firmly against the underside of the PITT Cooking unit and tighten the upper two screws completely. Then, tighten the lower screws completely.

# PITT

COOKING

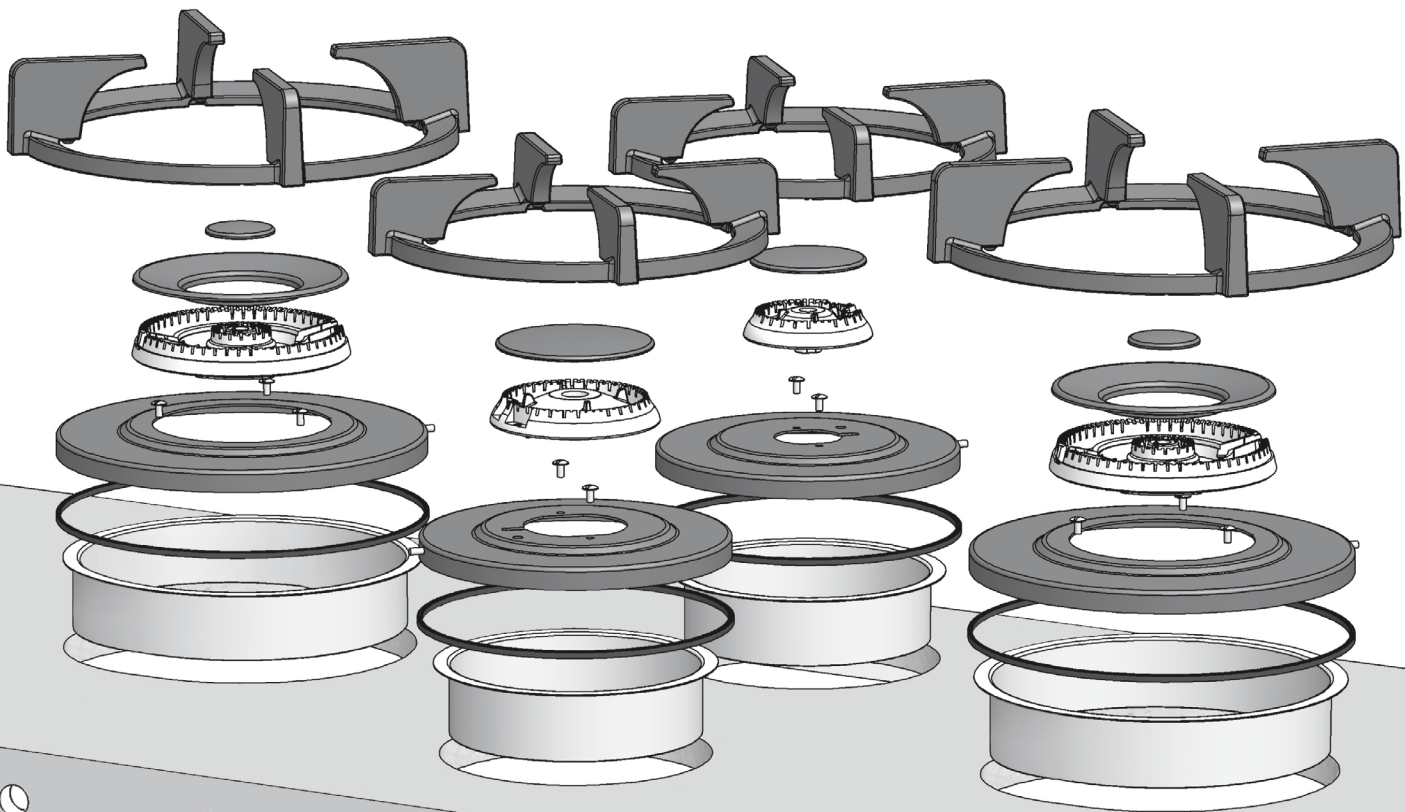

FR Notice de montage

Gas  
Front Side

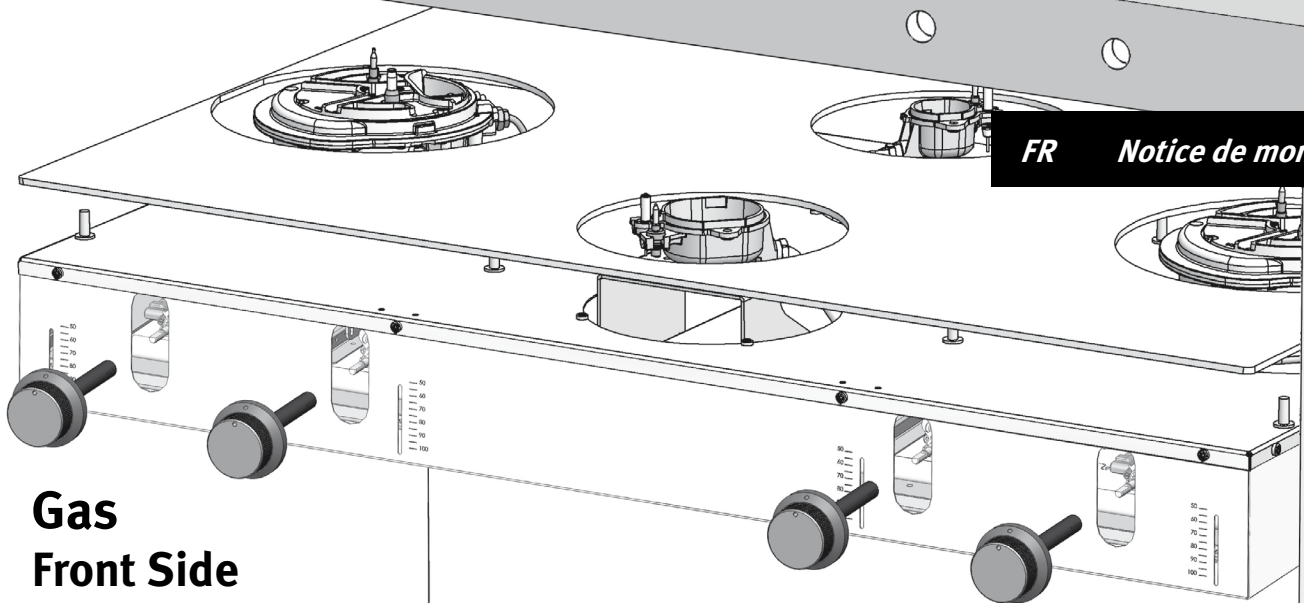

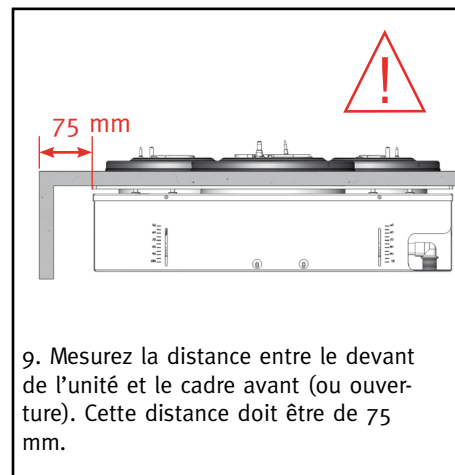
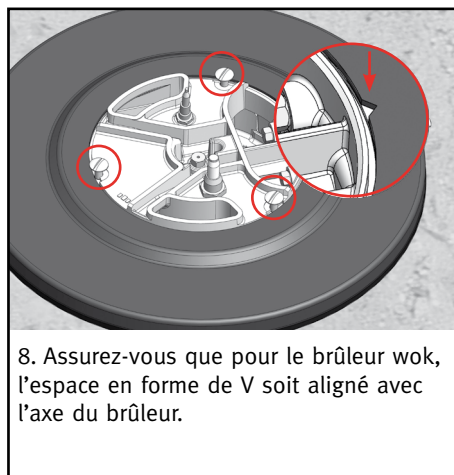
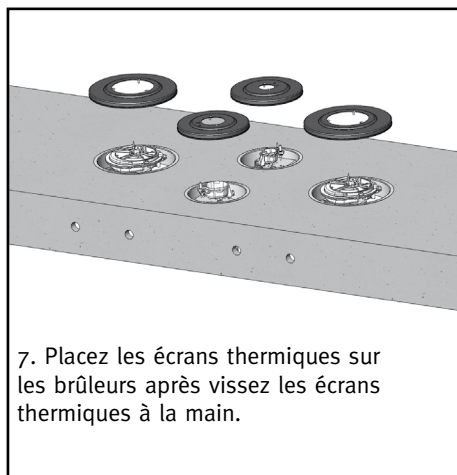
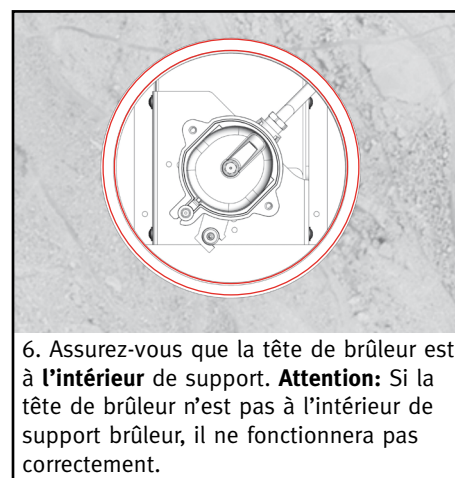
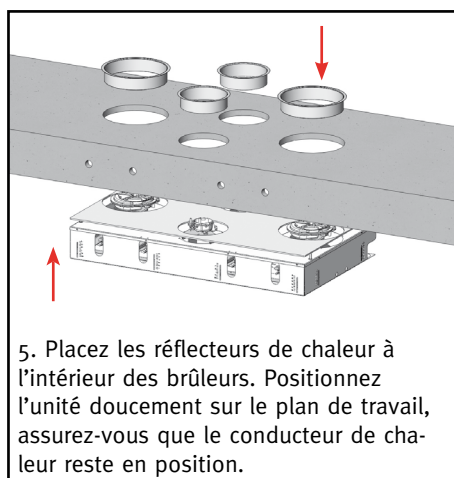
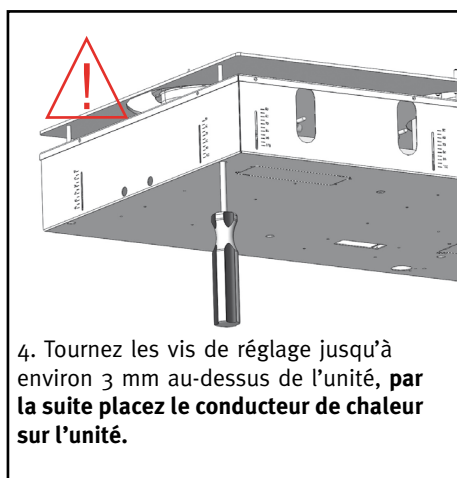
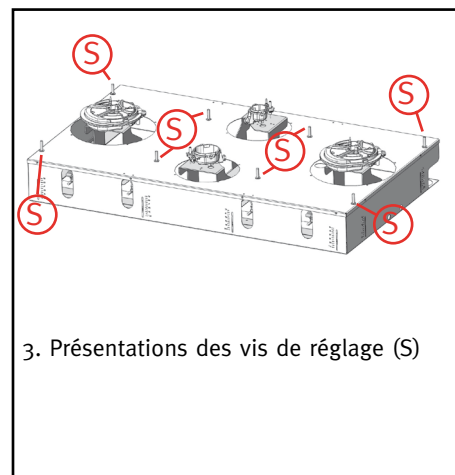
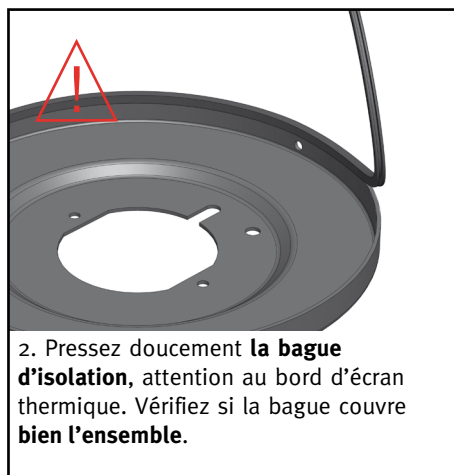
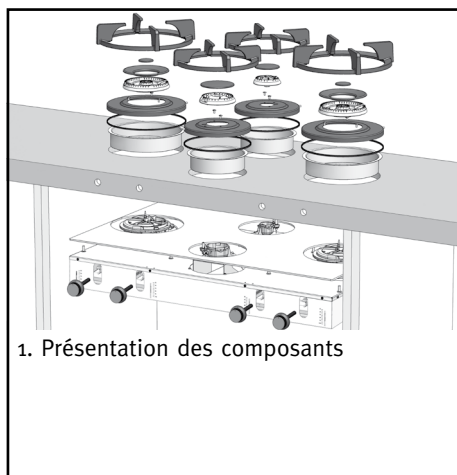

## Attention!

En cas de mauvais réglage des boutons de commande les brûleurs ne s'allumeront pas ou pas bien.

Pour que la **garantie** et le **bon fonctionnement** de l'unité de cuisson soit assuré, il faut que le montage soit scrupuleusement effectué conformément aux descriptions.

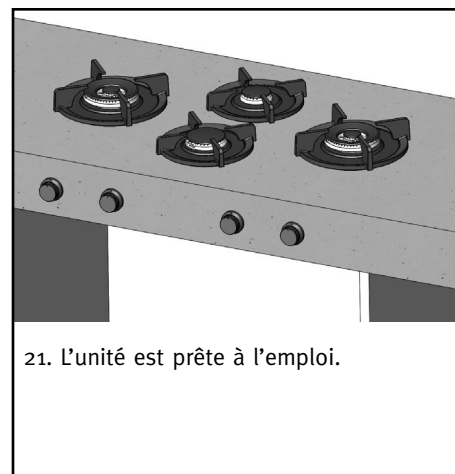
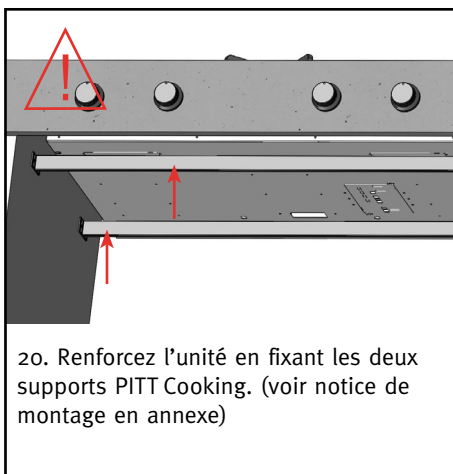
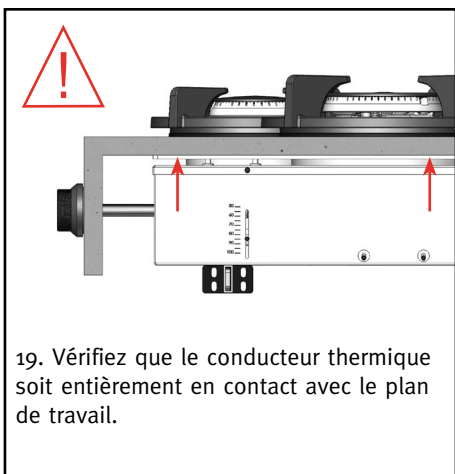
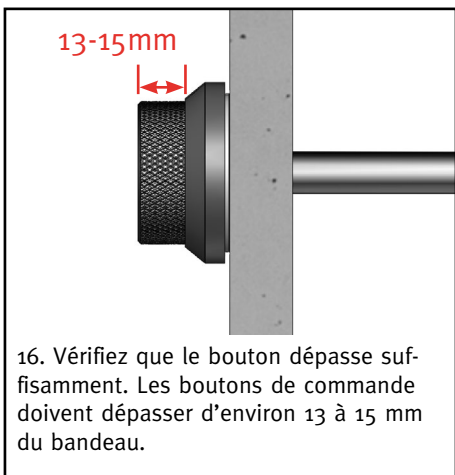
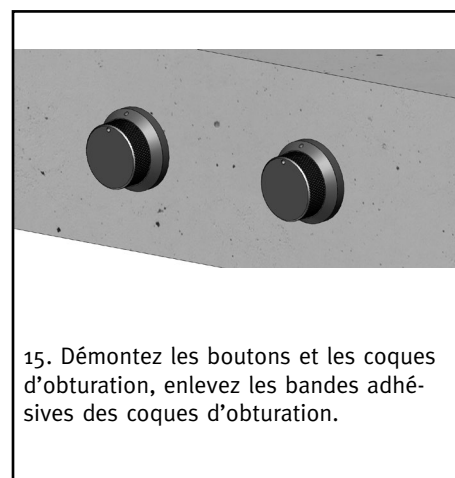
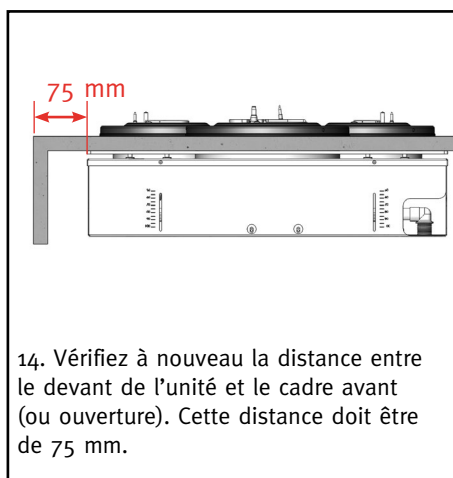
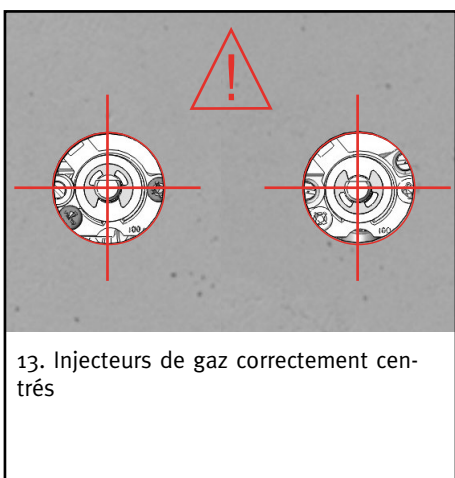
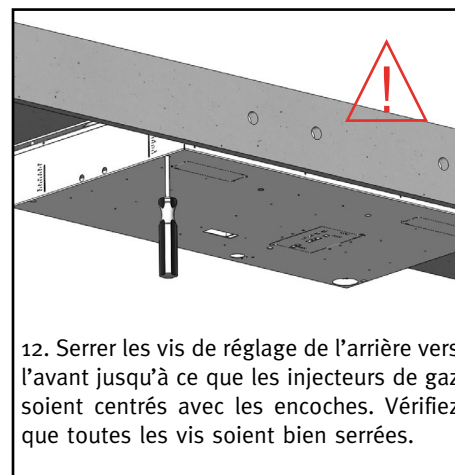
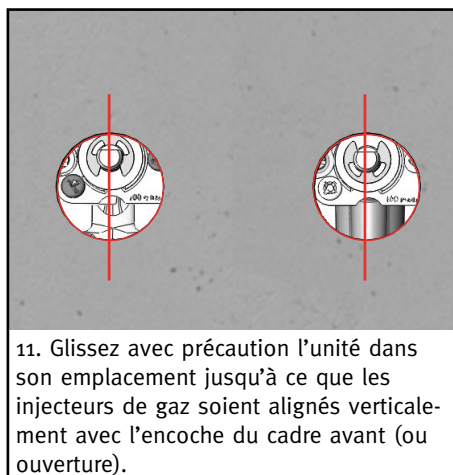

# Instruction de montage du support

## Contenu de l'emballage:

2x lattes de soutien



4x pièces d'accroche



16x vis à tête cruciforme 4,2 x 16 mm



## Outils requis :

- Mètre ruban
- Tournevis cruciforme
- Scie à métaux



1. Déterminez les dimensions de l'armoire et sciez les lattes de soutien. **NOTEZ BIEN ! La bonne longueur des lattes = Dimension de l'intérieur de l'armoire - 4mm.**

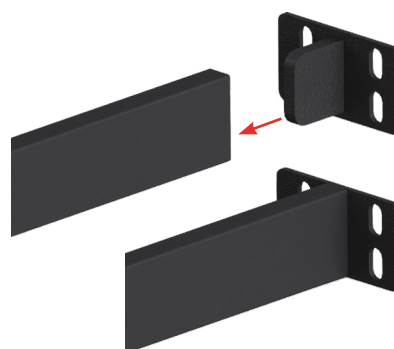

2. Placez les pièces d'accroche aux extrémités des lattes de soutien préalablement sciez à la bonne dimension.

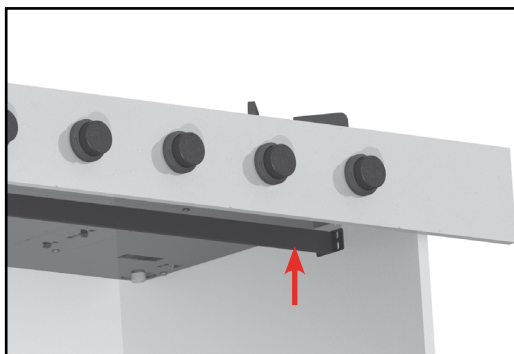

3. Placez la latte de soutien entre l'armoire et positionnez-la contre le dessous de l'appareil de cuisson PITT Cooking. **VÉRIFIEZ BIEN LE POSITIONNEMENT, REPORTEZ-VOUS À L'ÉTAPE 4 !**

\* Distance minimale de 80 mm

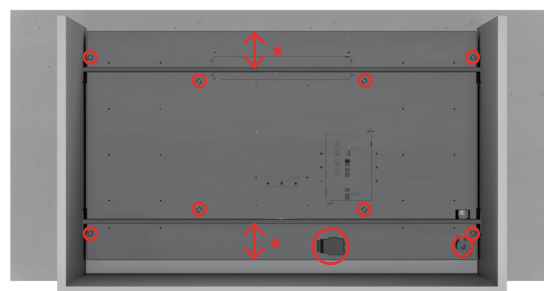

4. Mettez la barre de soutien de manière à ce que les vis de réglage, le branchement de la conduite de gaz et le bloc électrique soient facilement accessibles.

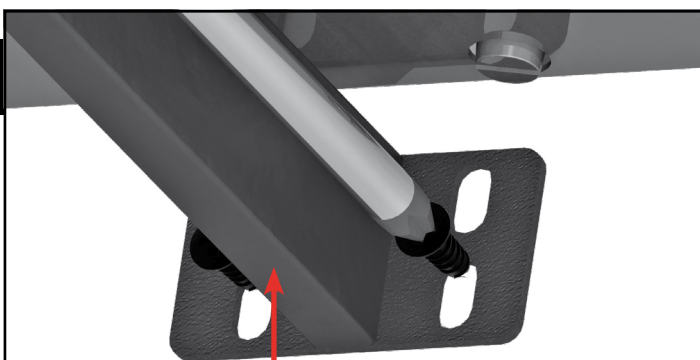

5. Poussez la latte de soutien fermement contre le dessous de l'appareil de cuisson et serrez légèrement les deux vis du bas. Répétez cette action pour l'autre côté de l'armoire.

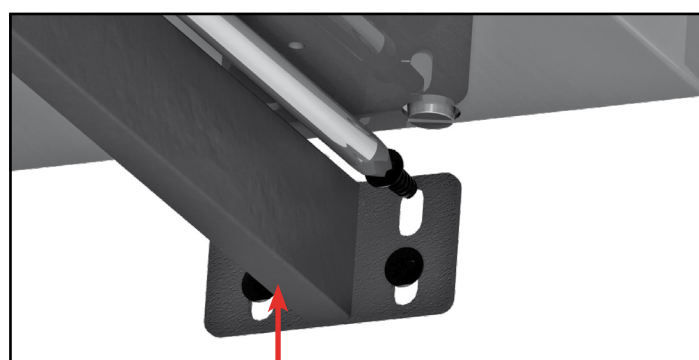

6. Poussez la latte de soutien fermement contre le dessous de l'appareil de cuisson PITT Cooking et serrez entièrement les deux vis du haut et ensuite serrez entièrement les vis du bas.

# PITT

COOKING

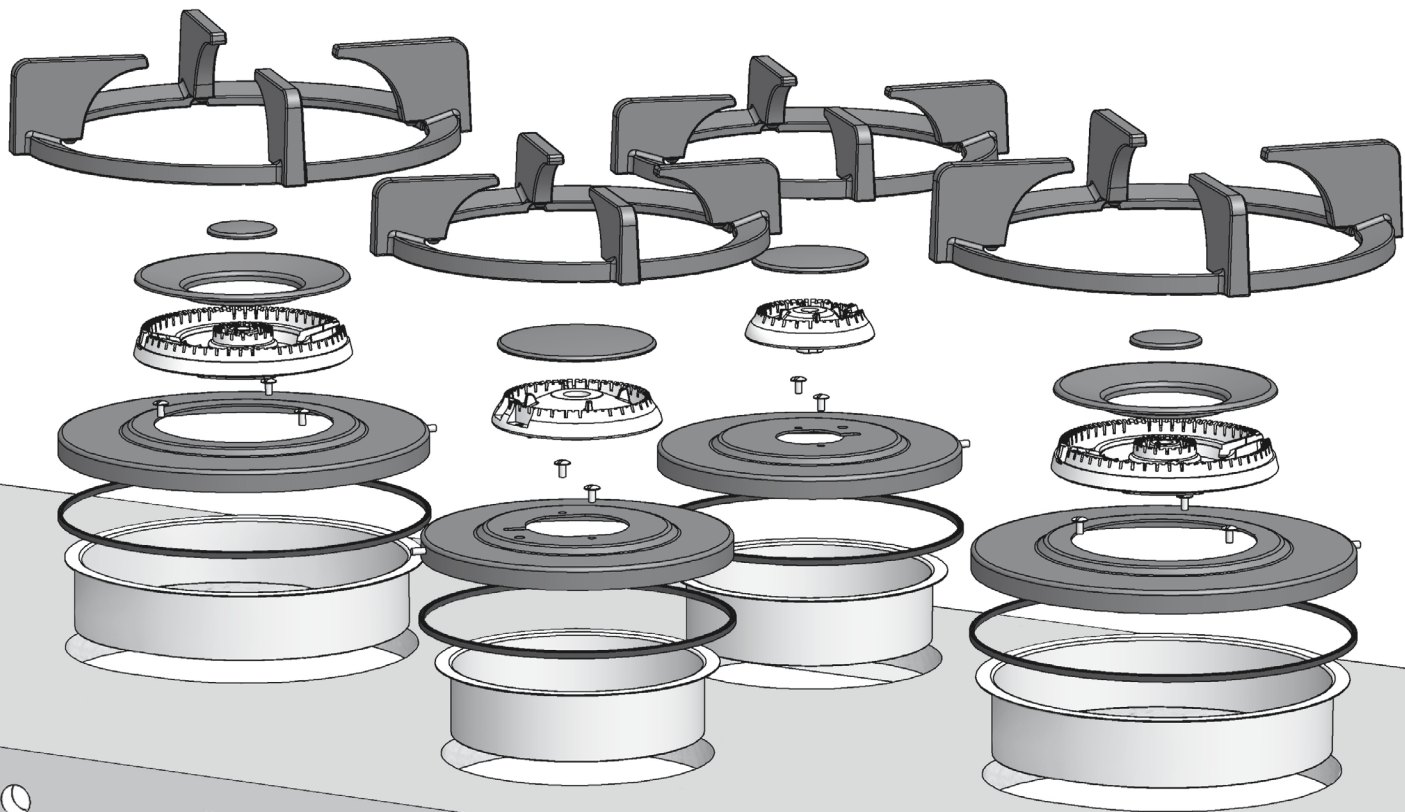

DE *Montageanleitung*

**Gas  
Front Side**

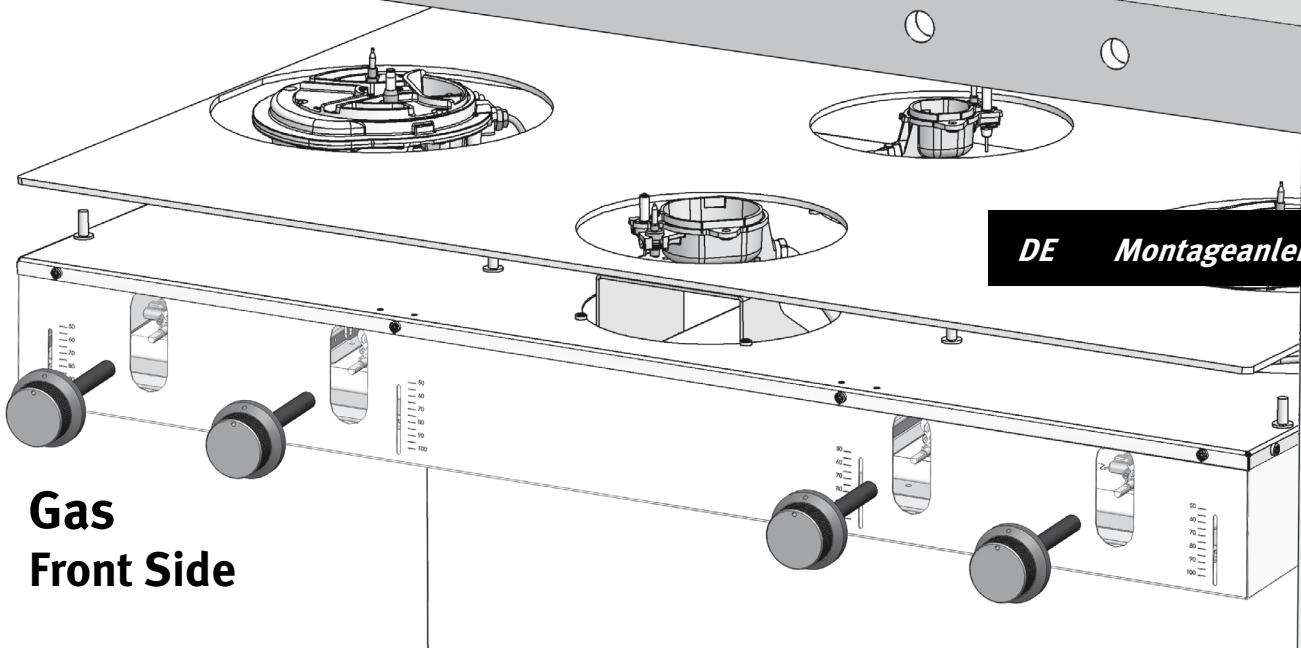

# Montageanleitung Front Side

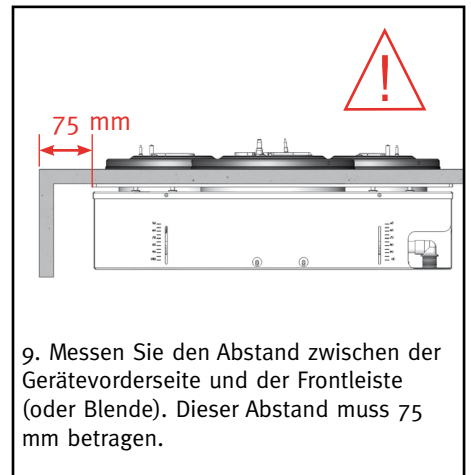
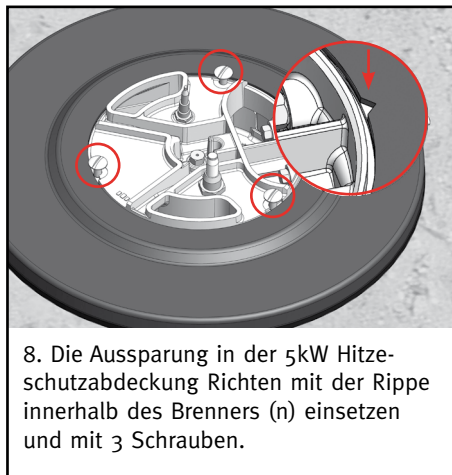
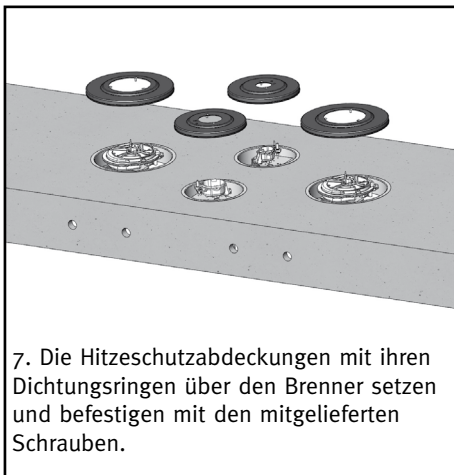
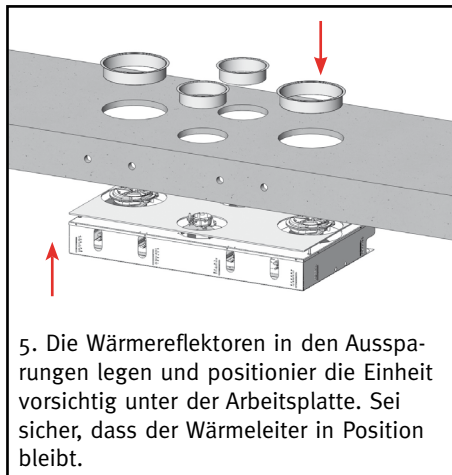
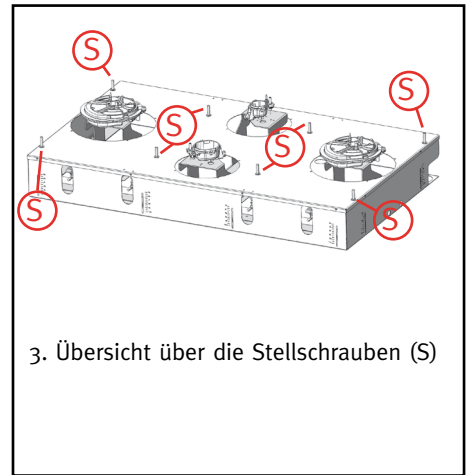
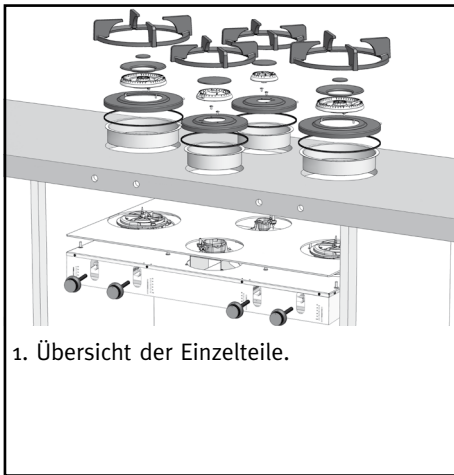

## Wichtiger Hinweis!

Wenn die Regelknöpfe nicht korrekt eingestellt werden, lassen sich die Brenner nicht oder schlecht zünden.

Zur Gewährleistung der **Garantie** und des **einwandfreien Funktionierens der Kocheinheit** muss die Montage, wie in dieser Anleitung beschrieben, sorgfältig ausgeführt werden.





10. Die **Schutzfolie nicht trennen** von dem Klebestreifen für die nächsten Schritte!

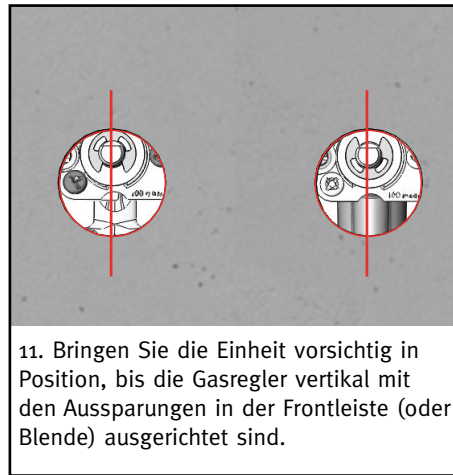

11. Bringen Sie die Einheit vorsichtig in Position, bis die Gasregler vertikal mit den Aussparungen in der Frontleiste (oder Blende) ausgerichtet sind.

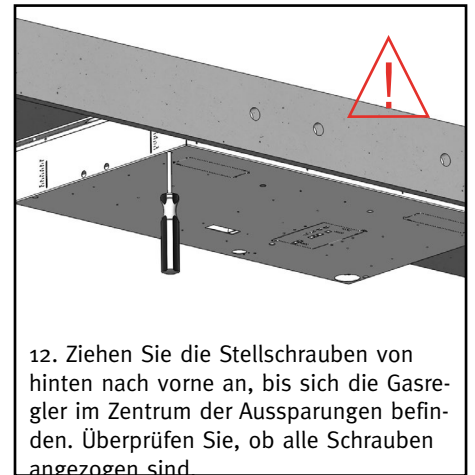

12. Ziehen Sie die Stellschrauben von hinten nach vorne an, bis sich die Gasregler im Zentrum der Aussparungen befinden. Überprüfen Sie, ob alle Schrauben angezogen sind.

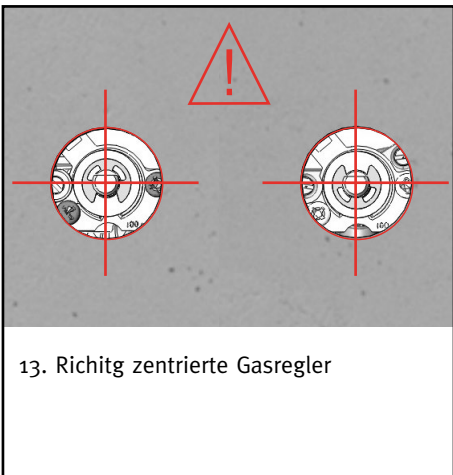

13. Richtig zentrierte Gasregler

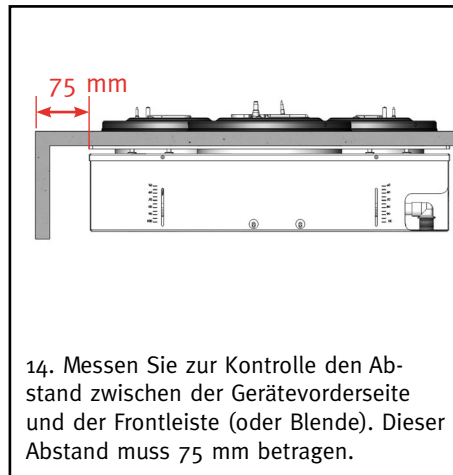

14. Messen Sie zur Kontrolle den Abstand zwischen der Gerätevorderseite und der Frontleiste (oder Blende). Dieser Abstand muss 75 mm betragen.



15. Entfernen die Schutzfolie von der Dichtmanschette und drücken den Knopf und Dichtmanschette als Ganzes. Die punkten ausgerichtet und konzentrisch.

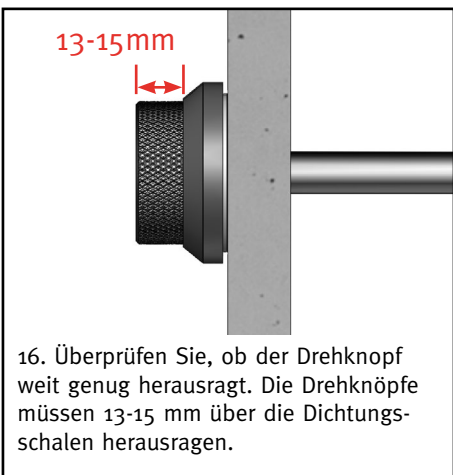

16. Überprüfen Sie, ob der Drehknopf weit genug herausragt. Die Drehknöpfe müssen 13-15 mm über die Dichtungsschalen herausragen.



17. Überprüfen den Knopf (n), wenn sie genügend Platz zu schieben und drehen haben. Wenn nicht die Dichtmanschette entfernen und wieder aufkleben.



18. Schließ das Gerät an zu Gas und strom und zünd die Brenner. Wenn die **Flammen** nach der Zündung **löschen überprüf den Knopf in Schritt 9 wieder.**

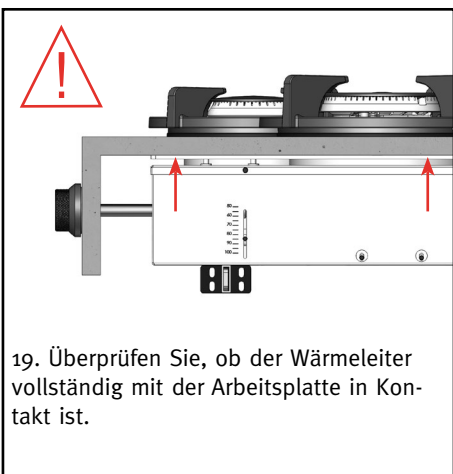

19. Überprüfen Sie, ob der Wärmeleiter vollständig mit der Arbeitsplatte in Kontakt ist.

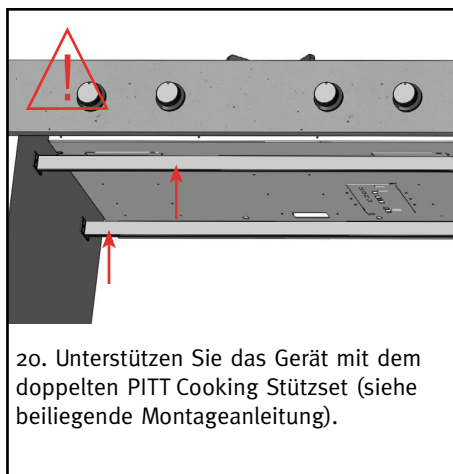

20. Unterstützen Sie das Gerät mit dem doppelten PITT Cooking Stützet (siehe beiliegende Montageanleitung).



21. Das Gerät ist nun einsatzbereit.

# Montageanleitung Stützbalken-Set

## Verpackungsinhalt:

2x Stützbalken



4x Einsatzstücke



16x Kreuzschlitzschrauben 4,2x16 mm



## Benötigtes Werkzeug:

- Maßband
- Kreuzschlitzschraubenzieher
- Metallsäge

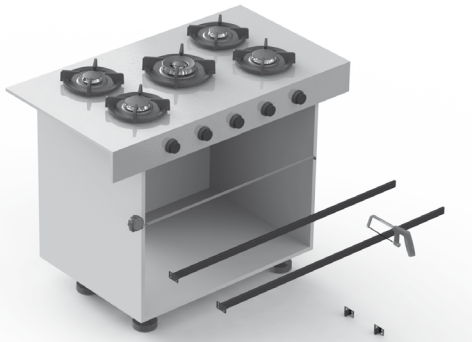

1. Bestimmen Sie die Abmessungen des Schrankes und sägen Sie die Stützbalken ab. **ACHTUNG! Richtige Balkenlänge = Maß Schrankinnenseite - 4 mm.**

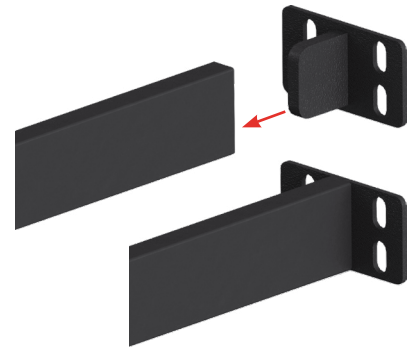

2. Platzieren Sie die Einsatzstücke in die Enden der auf Maß gesägten Stützbalken.

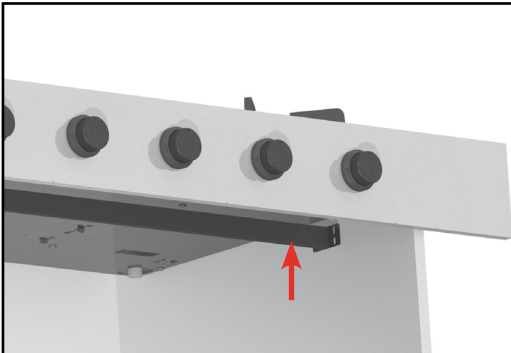

3. Setzen Sie den Stützbalken in den Schrank ein, und positionieren Sie ihn an der Unterseite des PITT Cooking Kocheinheit. **ACHTEN SIE AUF DIE POSITIONIERUNG, SIEHE SCHRITT 4!**

\* Mindestabstand von 80 mm

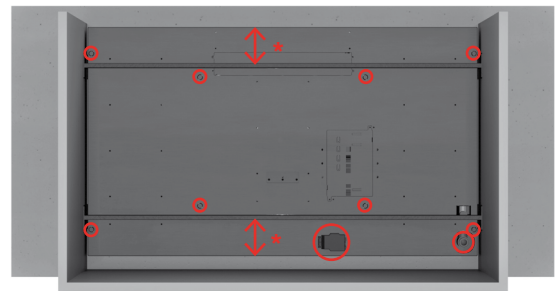

4. Positionieren Sie den Stützbalken so, dass die Stellschrauben, sowie der Gas- und Stromanschluss frei zugänglich sind.

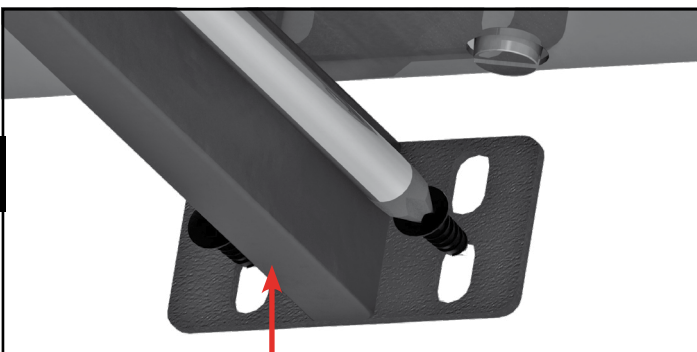

5. Drücken Sie den Stützbalken fest gegen die Unterseite der PITT Cooking Kocheinheit und ziehen Sie die untersten beiden Schrauben handfest an. Wiederholen Sie diesen Schritt auf der anderen Seite des Schrankes.

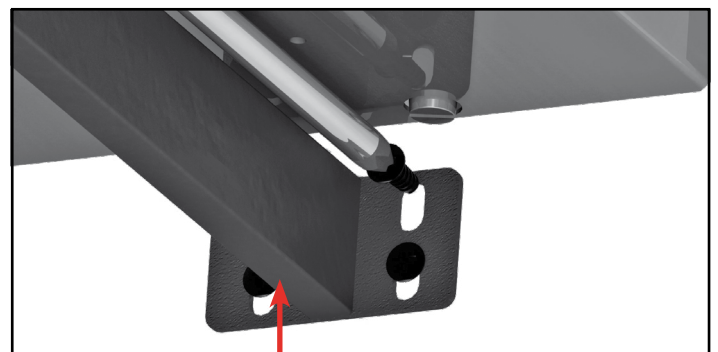

6. Drücken Sie den Stützbalken fest gegen die Unterseite der PITT Cooking Kocheinheit und ziehen Sie erst die oberen beiden Schrauben komplett an und anschließend auch die unteren Schrauben.

# PITT

COOKING

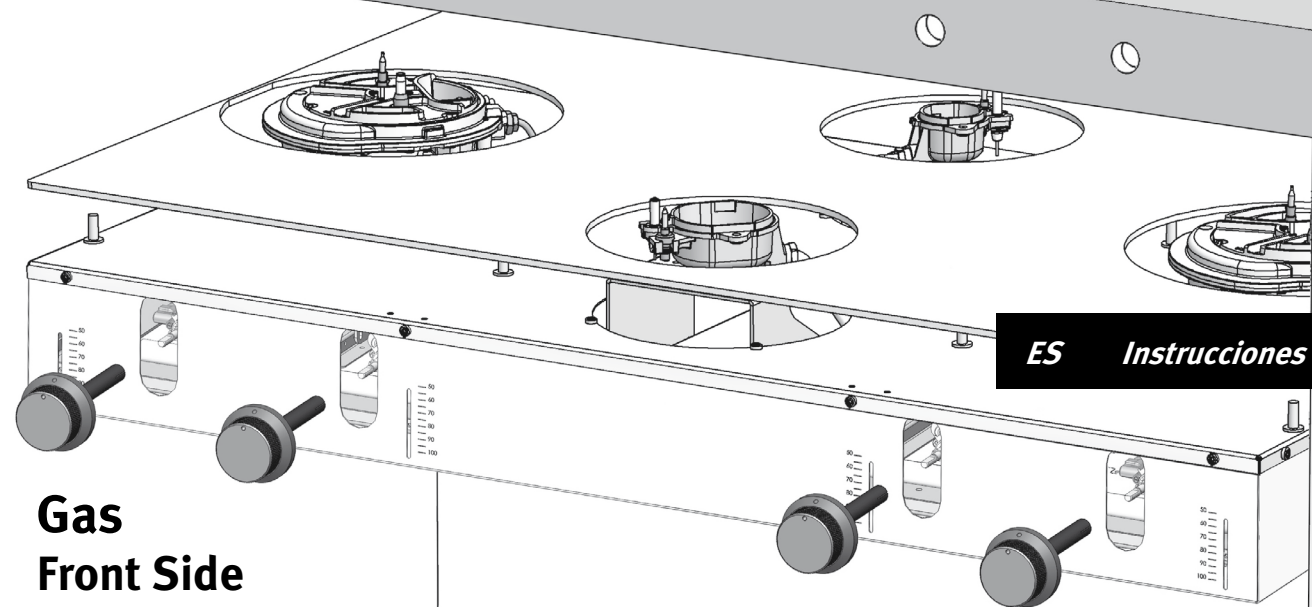
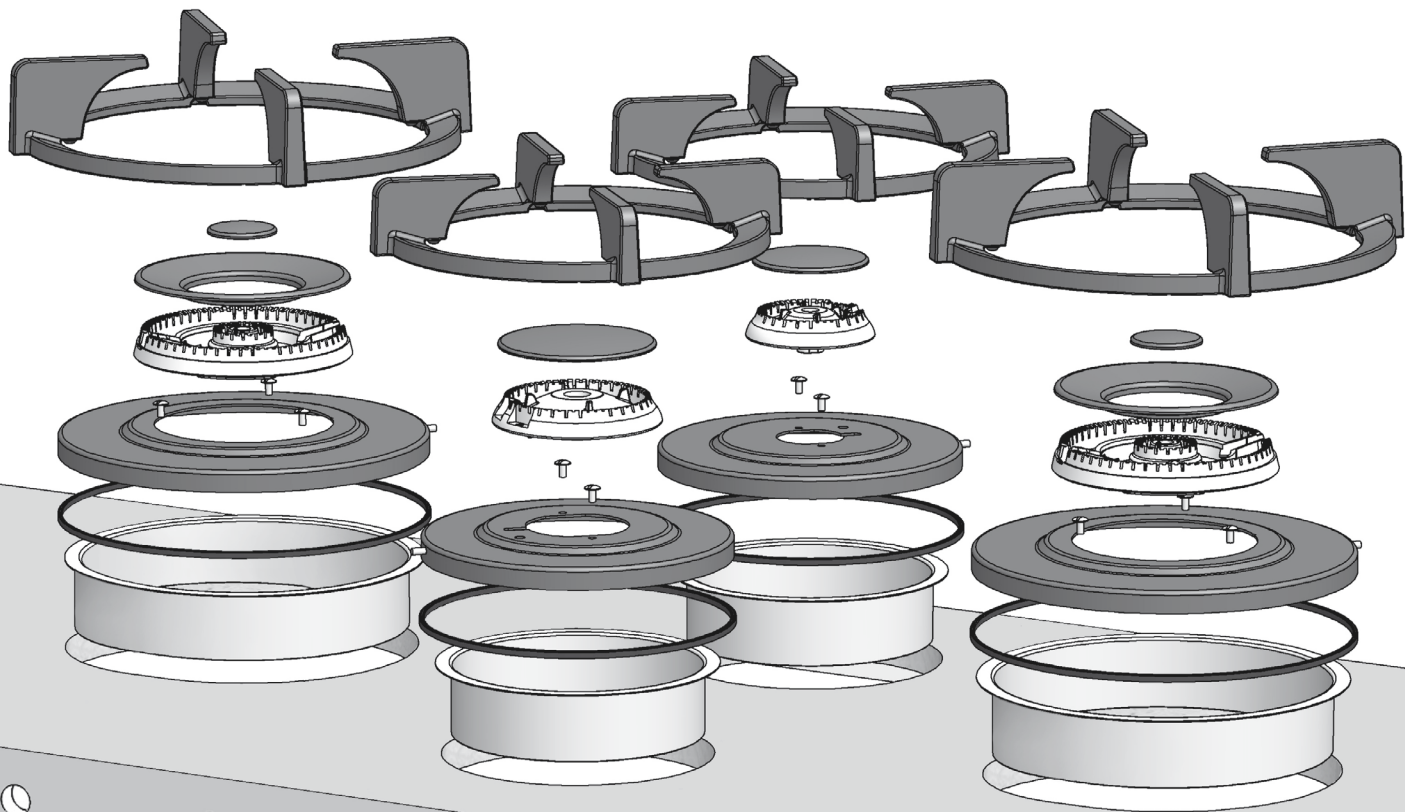

**Gas**  
**Front Side**

**ES** *Instrucciones de instalación*

## Instrucciones de instalación Front Side

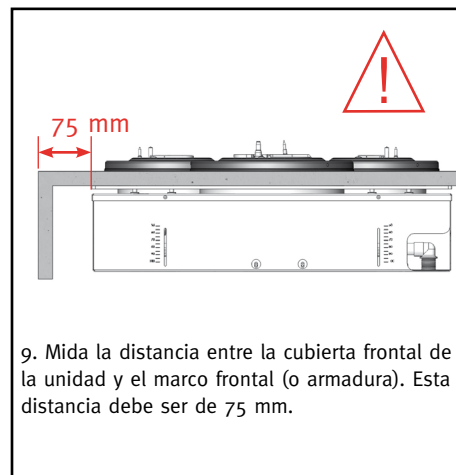
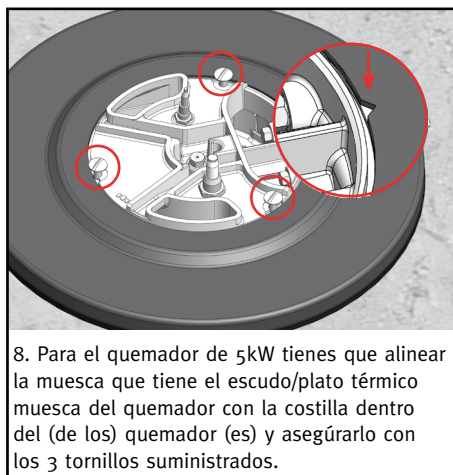
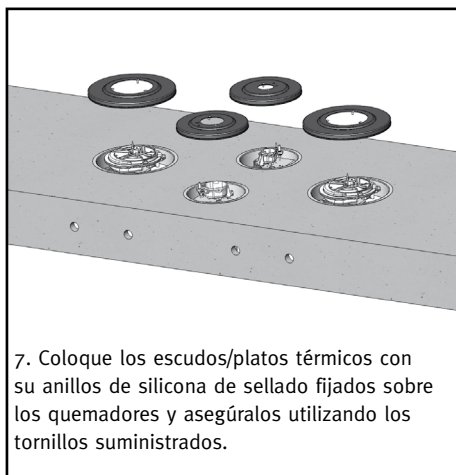
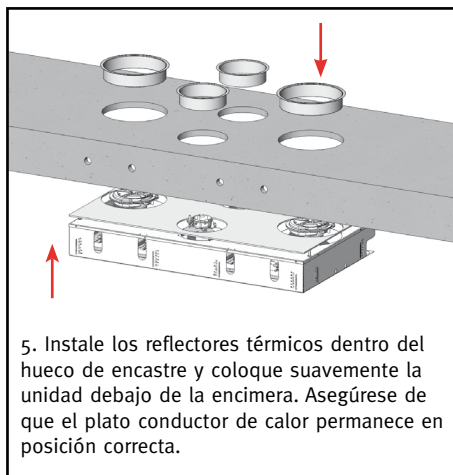
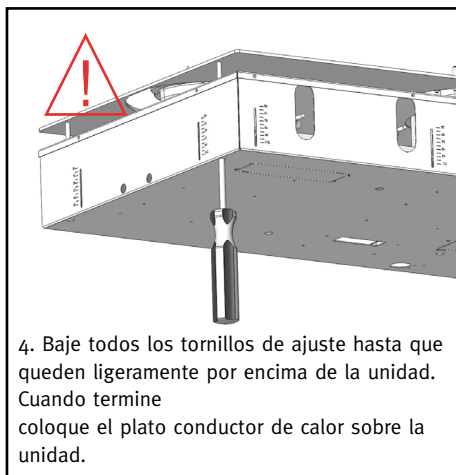
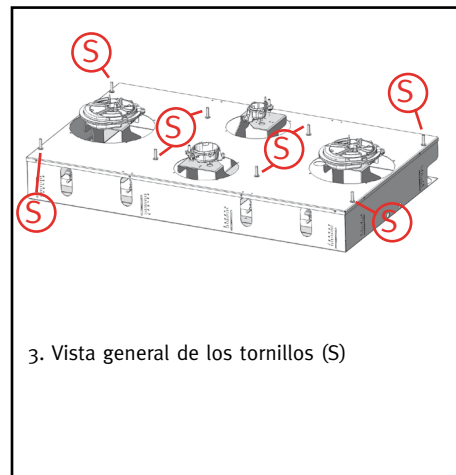
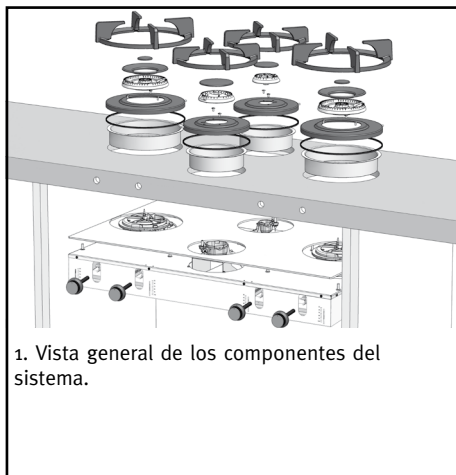

### ¡Importante!

Cuando los mandos no estén correctamente ajustados, los fuegos no se encenderán ni quemarán uniformemente.

Para la garantía y un buen correcto funcionamiento del sistema de cocción, asegúrate de seguir *exactamente* todas las etapas descritas en este manual de instalación.





10. No despegar la película protectora de la tira adhesiva del aro del mando que apoyará en la encimera, antes de continuar con los siguientes pasos!

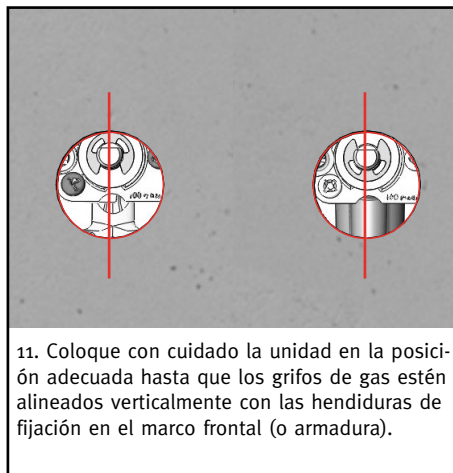

11. Coloque con cuidado la unidad en la posición adecuada hasta que los grifos de gas estén alineados verticalmente con las hendiduras de fijación en el marco frontal (o armadura).

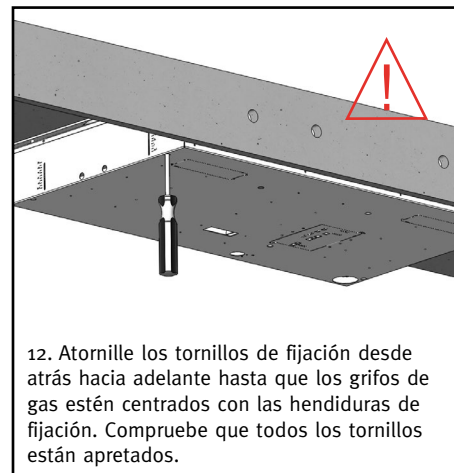

12. Atornille los tornillos de fijación desde atrás hacia adelante hasta que los grifos de gas estén centrados con las hendiduras de fijación. Compruebe que todos los tornillos están apretados.

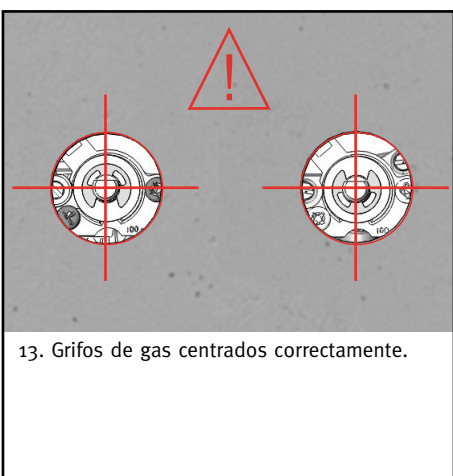

13. Grifos de gas centrados correctamente.

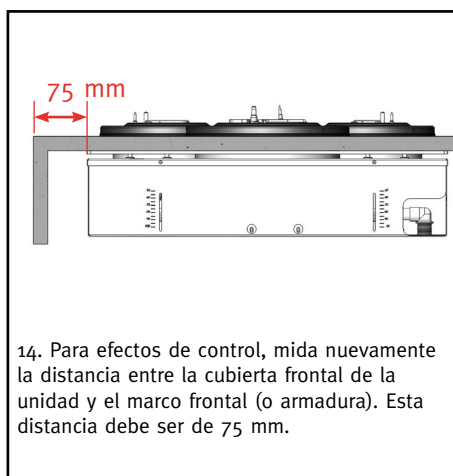

14. Para efectos de control, mida nuevamente la distancia entre la cubierta frontal de la unidad y el marco frontal (o armadura). Esta distancia debe ser de 75 mm.



15. Retira la película protectora de la tira adhesiva del aro del mando, asegúrate que el aro y el mando estén alineados y con-céntricos al hueco de encastre y presiona a la vez mano y aro asegurándote que se pega a la encimera correctamente.

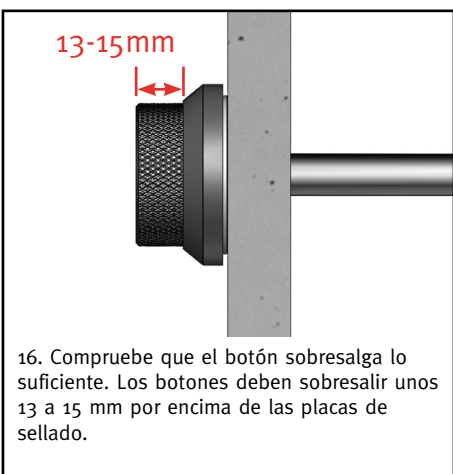

16. Compruebe que el botón sobresalga lo suficiente. Los botones deben sobresalir unos 13 a 15 mm por encima de las placas de sellado.



17. Compruebe si todos los mandos tienen suficiente espacio para empujar y girar suavemente sobre el aro sellado a la encimera. De no ser así, con cuidado despegue el aro de la encimera y pégalo de nuevo a la encimera en su posición correcta.

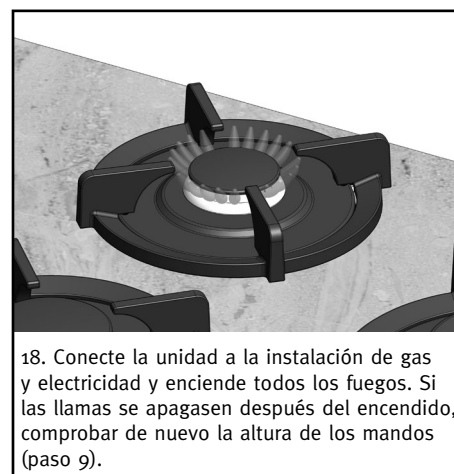

18. Conecte la unidad a la instalación de gas y electricidad y encienda todos los fuegos. Si las llamas se apagan después del encendido, comprobar de nuevo la altura de los mandos (paso 9).

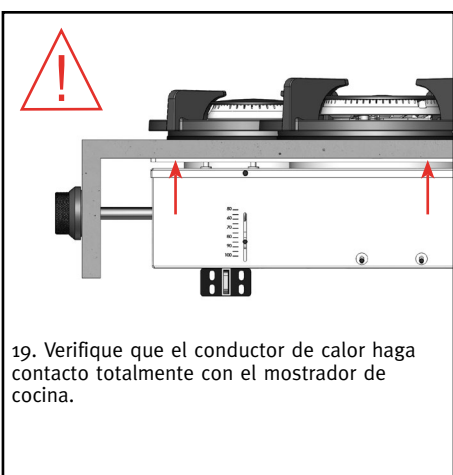

19. Verifique que el conductor de calor haga contacto totalmente con el mostrador de cocina.

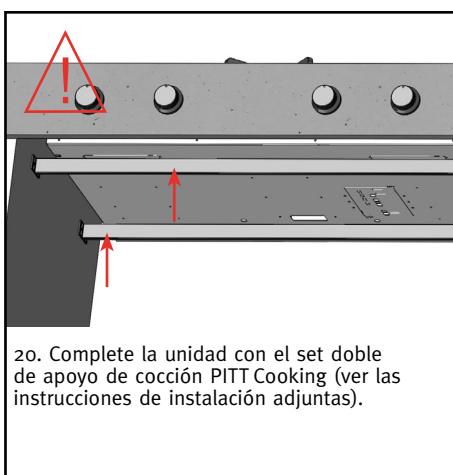

20. Complete la unidad con el set doble de apoyo de cocción PITT Cooking (ver las instrucciones de instalación adjuntas).



21. La unidad está lista para ser usada.

## Contenido del paquete:

2 barras de soporte



4 complementos



16 tornillos de estrella 4,2x16 mm



## Herramientas necesarias:

- Cinta métrica extensible
- Destornillador de estrella
- Sierra para metales



1. Determine las dimensiones del armario y corte las barras de soporte. **ATENCIÓN: Longitud correcta de la barra = Dimensiones del interior del armario - 4 mm.**

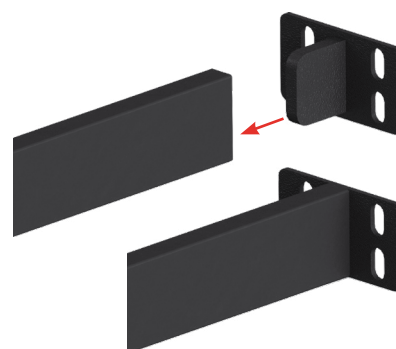

2. Coloque las piezas complementarias en los extremos de las barras de soporte cortadas a medida.

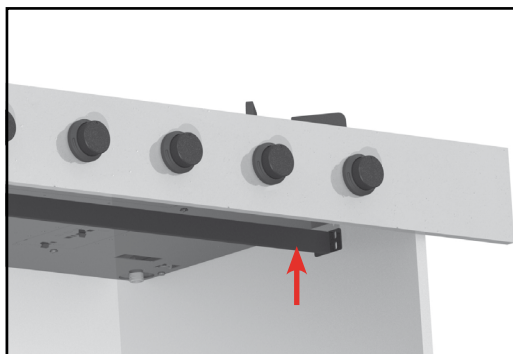

3. Ponga la barra de soporte en medio del armario y colóquela contra la parte inferior de la unidad PITT Cooking. **¡ATENCIÓN AL POSICIONAMIENTO, VEA PASO 4!**

\* Distancia mínima de 80 mm

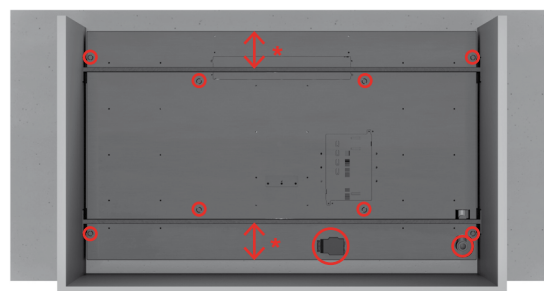

4. Coloque la barra de soporte de forma que los tornillos de ajuste, la conexión de gas y el bloque eléctrico sean de libre acceso.

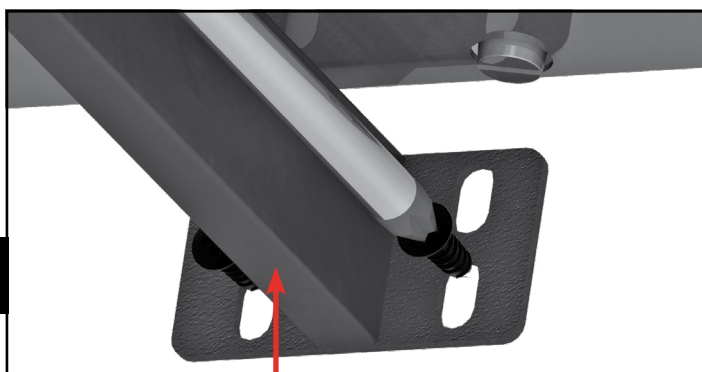

5. Empuje la barra de soporte firmemente contra la parte inferior de la unidad PITT Cooking y apriete a mano los dos tornillos inferiores. Repita este paso en el otro lado del armario.

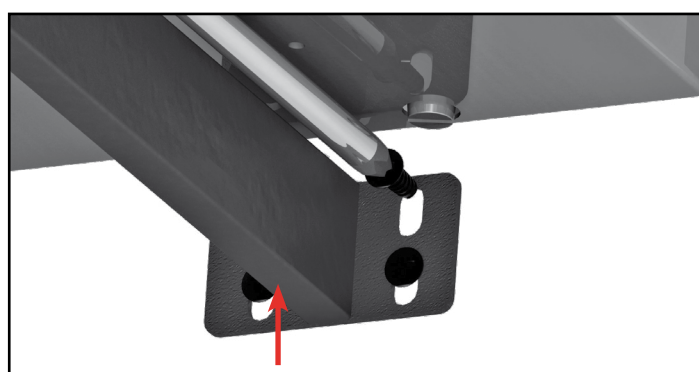

6. Empuje la barra de soporte firmemente contra la parte inferior de la unidad PITT Cooking y apriete completamente los dos tornillos superiores y luego los tornillos inferiores.

# PITT

COOKING

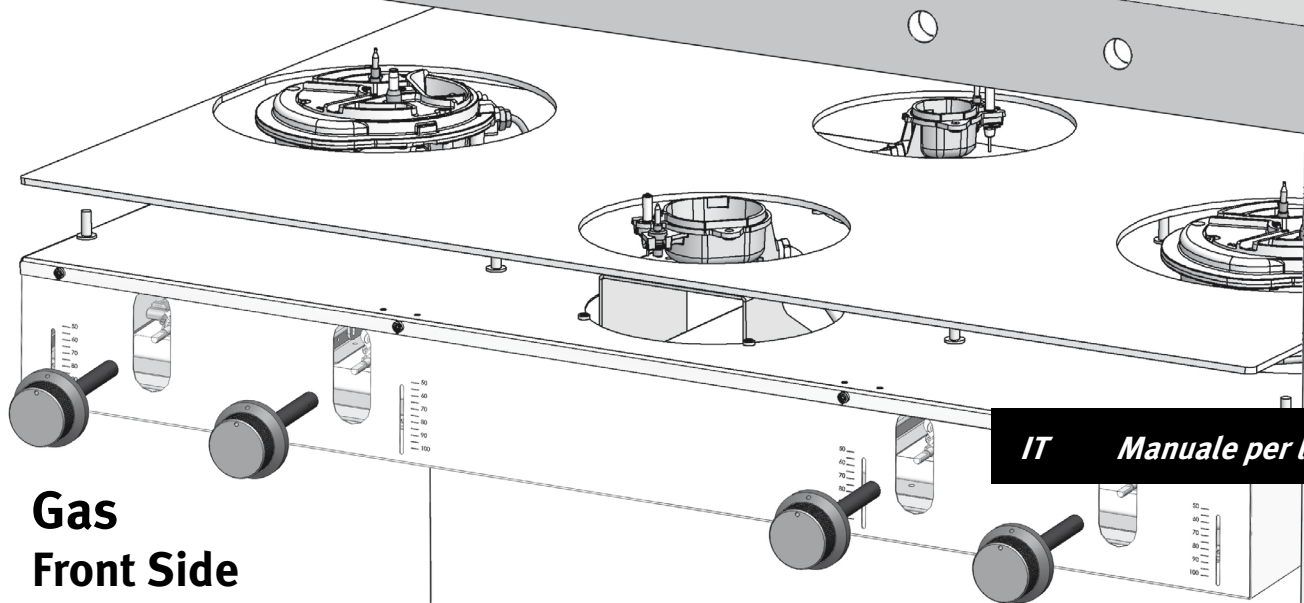
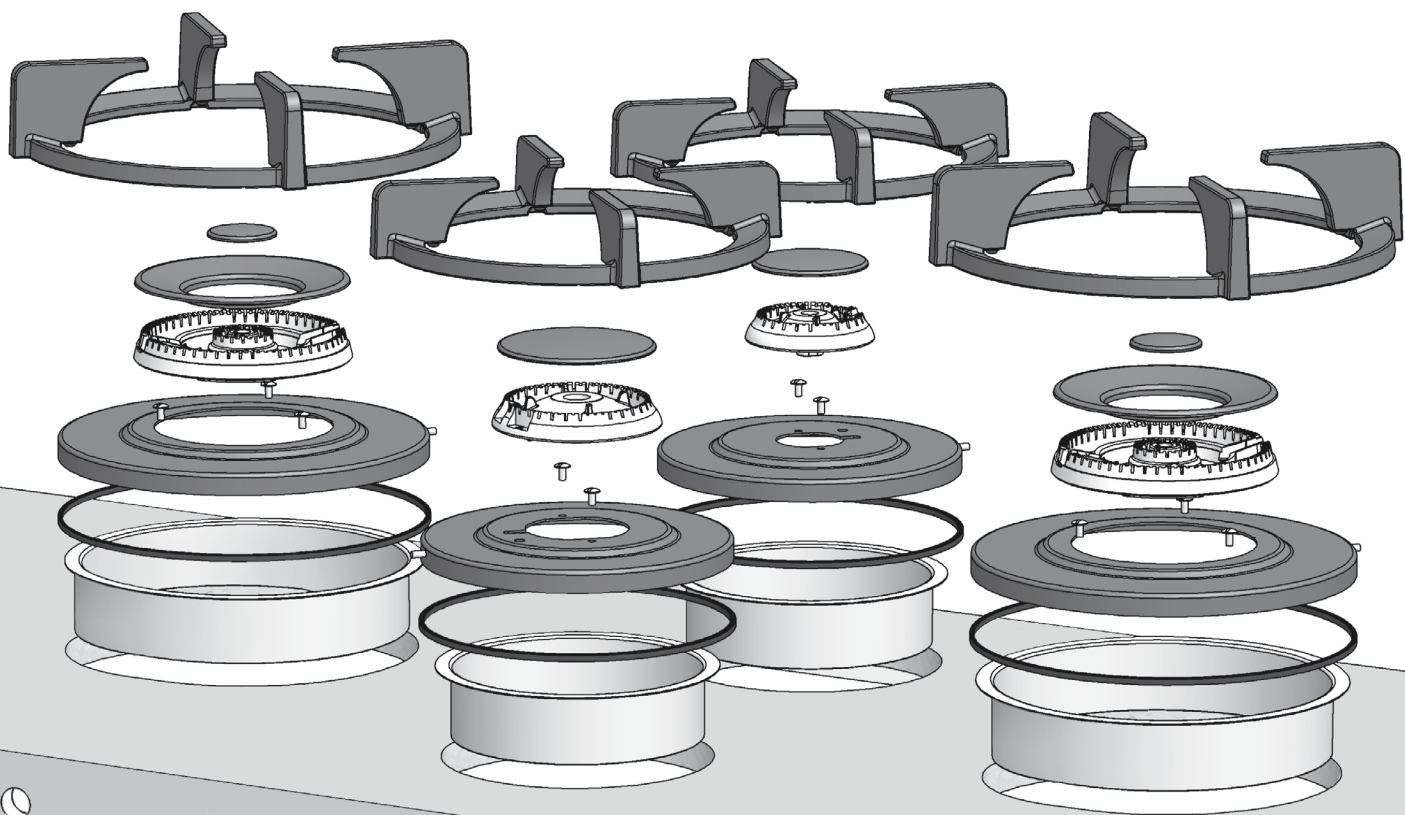

**Gas  
Front Side**

**IT** *Manuale per l'utente*

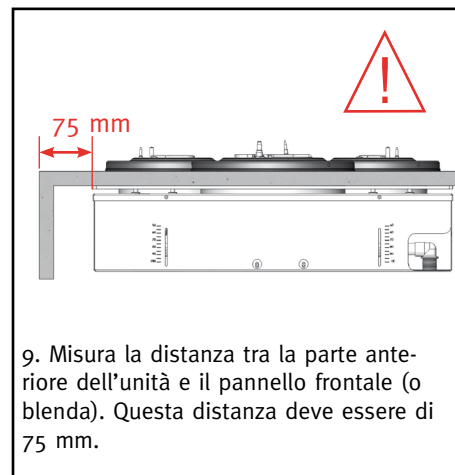
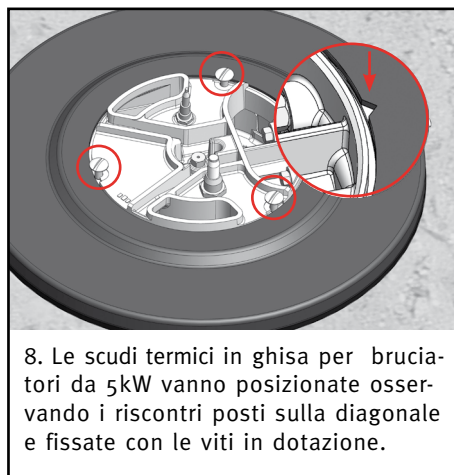
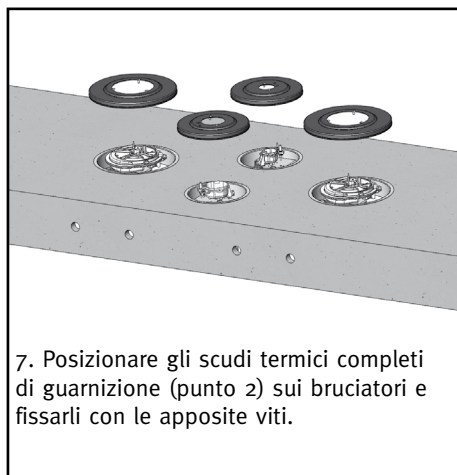
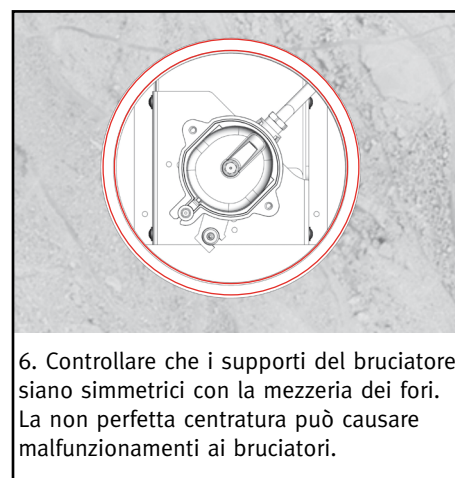
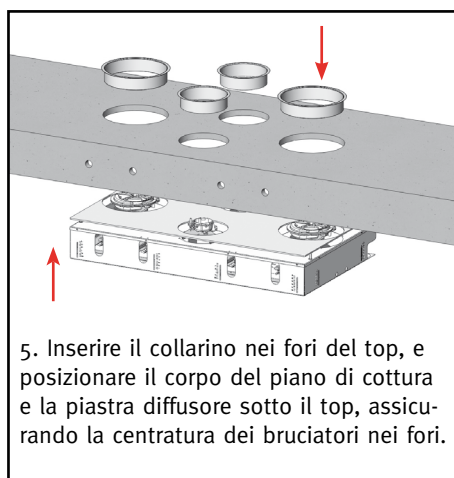
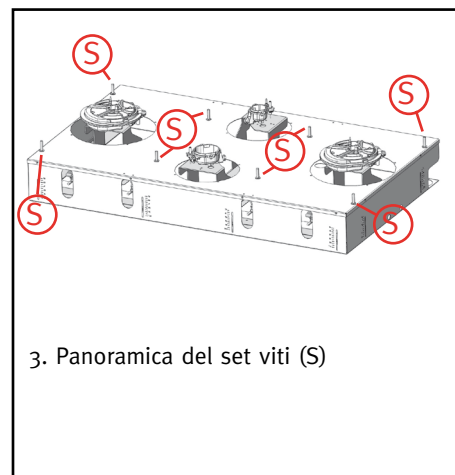
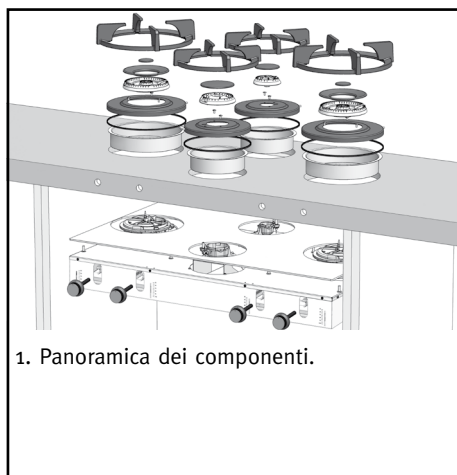

### Importante!

Se le manopole **non** sono regolate correttamente, i bruciatori non si accendono oppure producono un fuoco disomogeneo.

Per la validità della **garanzia** e il **funzionamento corretto** del piano cottura, assicurarsi che il montaggio venga effettuato esattamente con descritto nel presente manuale. the letter.





10. Le manopole di comando sono composte da due parti: la manopola e la base adesiva da fissare al top, come ultima operazione d'installazione.

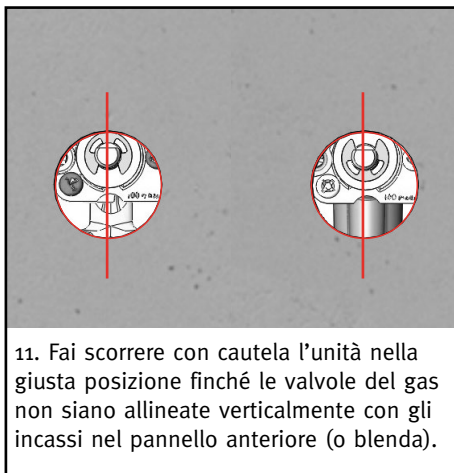

11. Fai scorrere con cautela l'unità nella giusta posizione finché le valvole del gas non siano allineate verticalmente con gli incassi nel pannello anteriore (o blende).

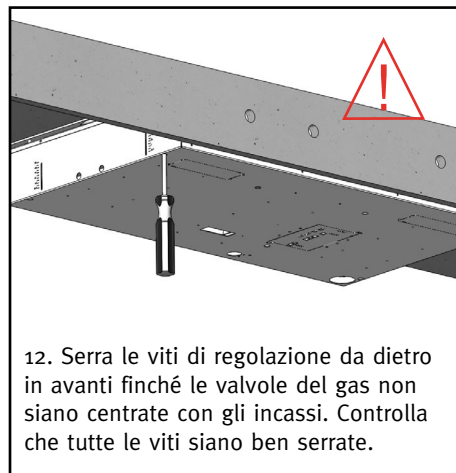

12. Serra le viti di regolazione da dietro in avanti finché le valvole del gas non siano centrate con gli incassi. Controlla che tutte le viti siano ben serrate.

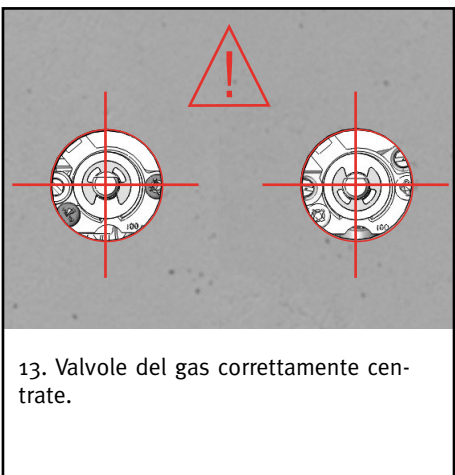

13. Valvole del gas correttamente centrate.

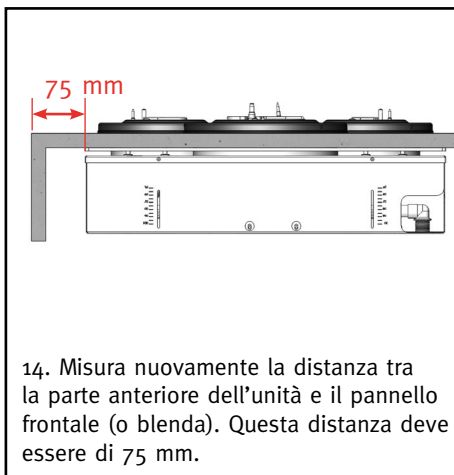

14. Misura nuovamente la distanza tra la parte anteriore dell'unità e il pannello frontale (o blende). Questa distanza deve essere di 75 mm.

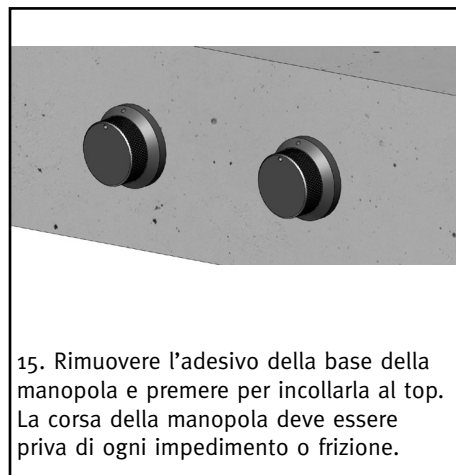

15. Rimuovere l'adesivo della base della manopola e premere per incollarla al top. La corsa della manopola deve essere priva di ogni impedimento o frizione.

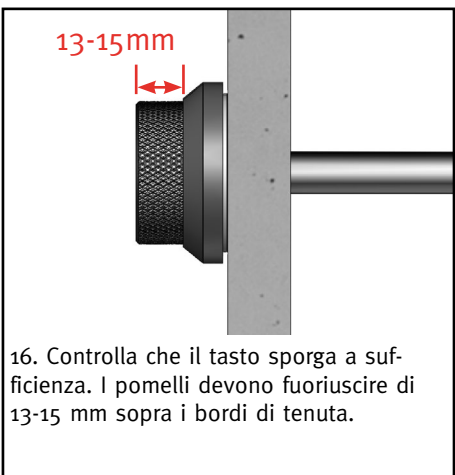

16. Controlla che il tasto sporga a sufficienza. I pomelli devono fuoriuscire di 13-15 mm sopra i bordi di tenuta.



17. Provare e riprovare più cicli di accensione e spegnimento per ciascun bruciatore posizionando la manopola sul massimo e sul minimo.

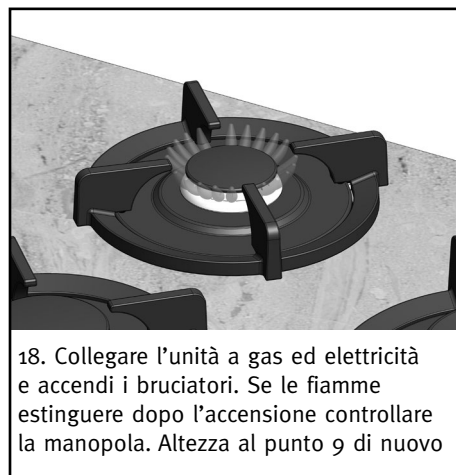

18. Collegare l'unità a gas ed elettricità e accendi i bruciatori. Se le fiamme estinguere dopo l'accensione controllare la manopola. Altezza al punto 9 di nuovo

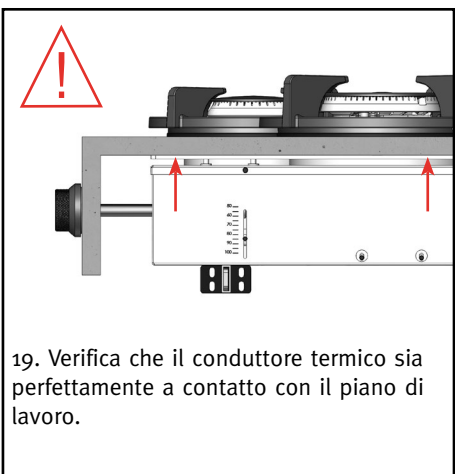

19. Verifica che il conduttore termico sia perfettamente a contatto con il piano di lavoro.

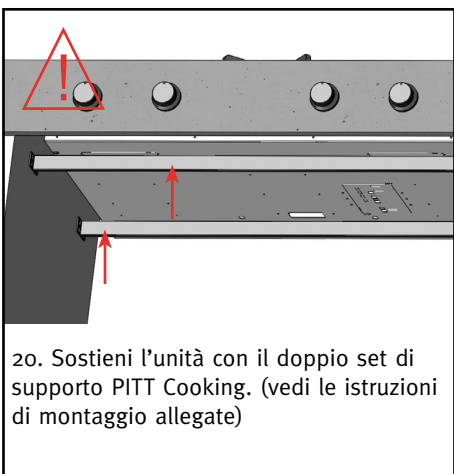

20. Sostieni l'unità con il doppio set di supporto PITT Cooking. (vedi le istruzioni di montaggio allegate)



21. L'unità è ora pronta per l'uso.

# Istruzioni di montaggio set di supporto

## Contenuto della confezione:

2x barre di supporto



4x inserti



16x viti con testa a croce 4,2x16 mm



## Attrezzi necessari:

- Metro a nastro
- Cacciavite a croce
- Sega per metalli



1. Determina le dimensioni del mobile e taglia le barre di supporto. **ATTENZIONE: Lunghezza corretta della barra = Dimensioni all'interno del mobile - 4 mm.**

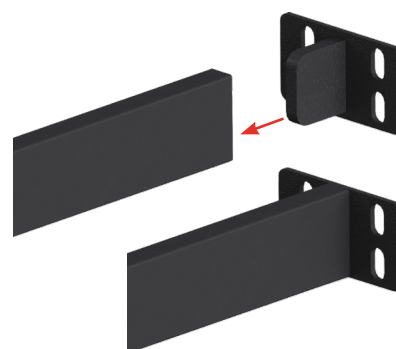

2. Posiziona gli inserti alle estremità delle barre di supporto tagliate su misura.

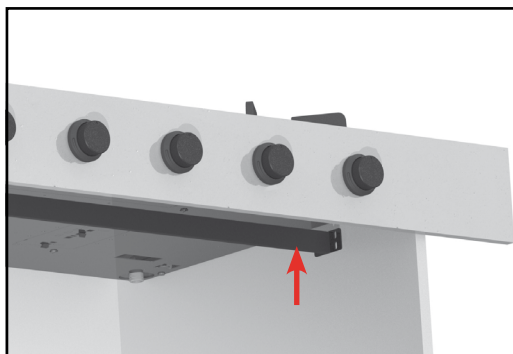

3. Inserisci la barra di supporto nel mobile e posizionala contro la parte inferiore dell'unità di cottura PITT Cooking. **ATTENZIONE AL POSIZIONAMENTO, VEDI PUNTO 4!**

\* Distanza minima di 80 mm

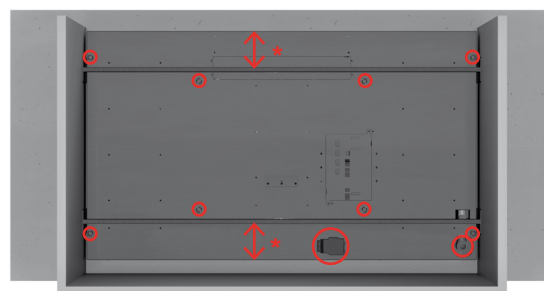

4. Posiziona la barra di supporto in modo che le viti di fissaggio, l'attacco del gas e il blocco elettrico siano facilmente accessibili.

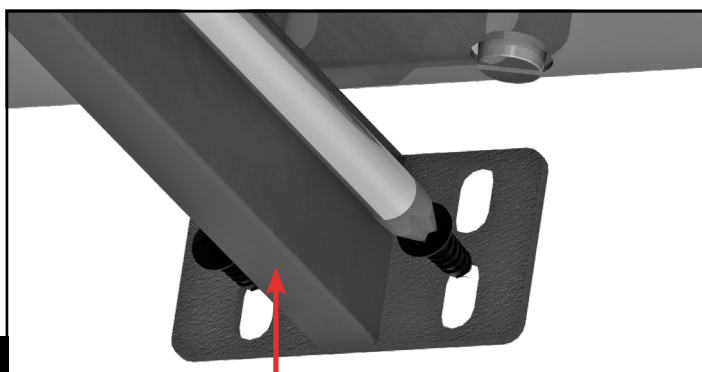

5. Spingi con forza la barra di supporto contro la parte inferiore dell'unità di cottura PITT Cooking e stringi a mano le due viti inferiori. Ripeti questo passaggio per l'altro lato del mobile.

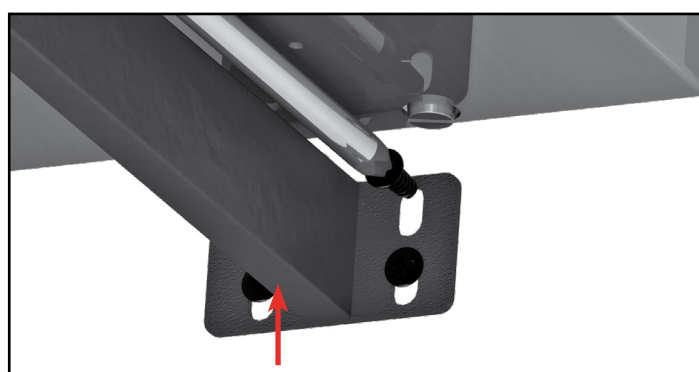

6. Spingi saldamente la barra di supporto contro la parte inferiore dell'unità di cottura PITT Cooking e stringi con forza prima le due viti superiori e poi quelle inferiori.









***Made in Holland***

---

PITT Cooking  
Damzigt 54  
3454 PS De Meern  
The Netherlands

T: +31 (0)88 088 70 70  
F: +31 (0)88 088 70 71  
[www.pittcooking.com](http://www.pittcooking.com)